

Comparative Details—Group 8

Interior Woodwork

Prepared for Pencil Points by Courtesy of the New York Architects' Emergency Unemployment Committee

Drawings by Roger Garland from Data Supplied by the Architects

THE ARCHITECTS

whose details are shown on this and the succeeding pages are as follows:

ROGER H. BULLARD
EVANS, MOORE
& WOODBRIDGE
HOWARD & FRENAYE
HYDE & SHEPHERD
WALTER BRADNEE KIRBY
MERRILL, HUMBLE
& TAYLOR

DETAILS PREVIOUSLY PUBLISHED

Dormers October, 1932
Fences and Gates
November, 1932
Radiator Enclosures
December, 1932
Second Story Overhangs
January, 1933
Fireplaces February, 1933
Door Hoods March, 1933
Chimneys April, 1933

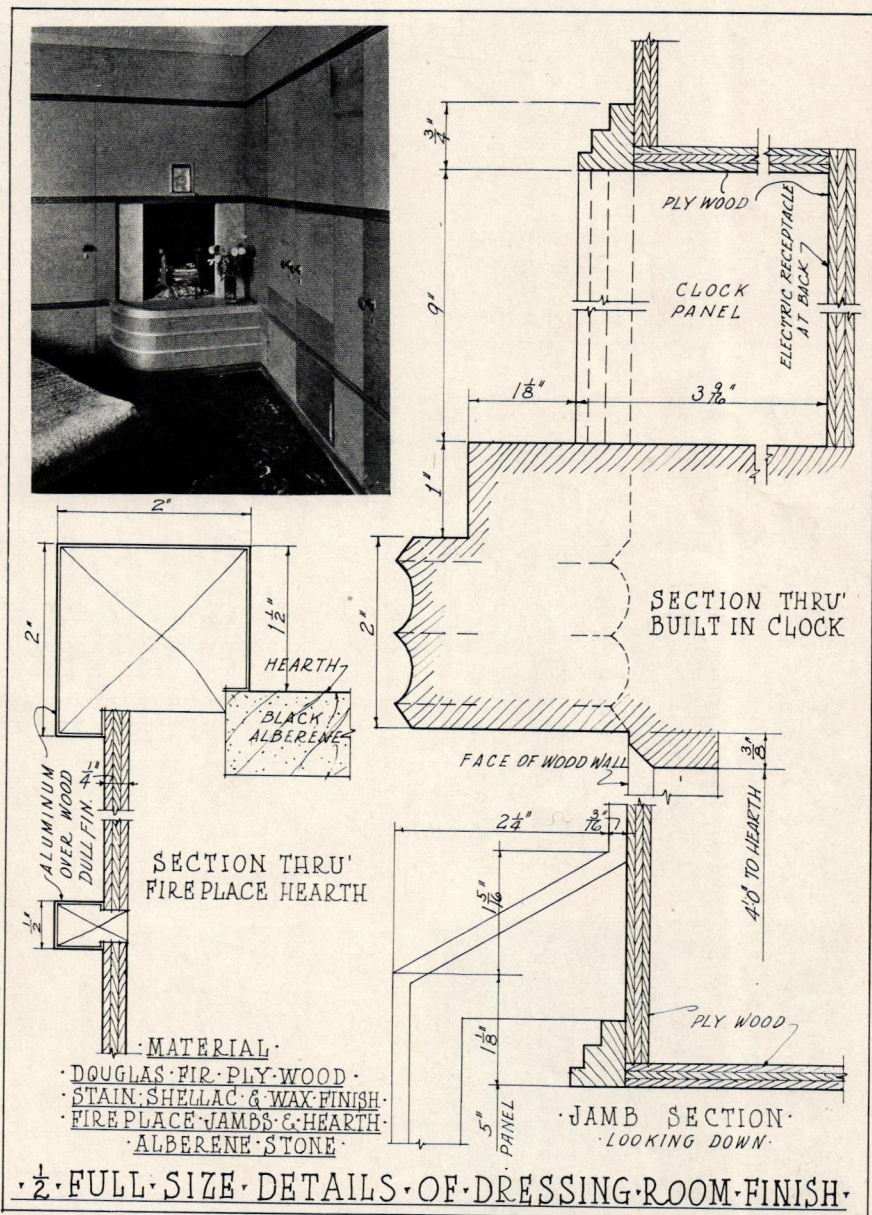

Photo by Gottscho

RESIDENCE OF H. W. HUBER, ESQ., RED BANK, NEW JERSEY

Howard and Frenaye, Architects

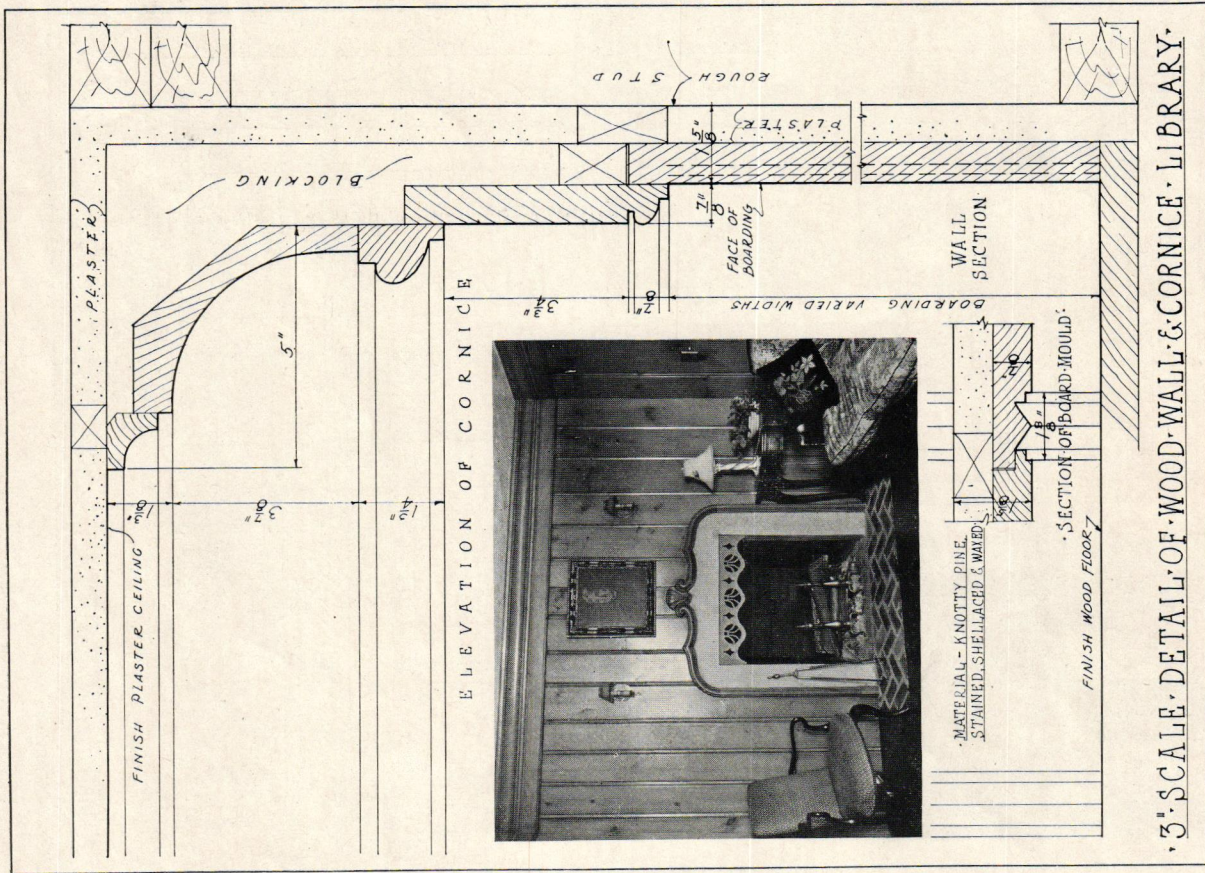

Photo by Gottscho

RESIDENCE OF H. W. HUBER, ESQ., RED BANK, NEW JERSEY

Howard and Frenaye, Architects

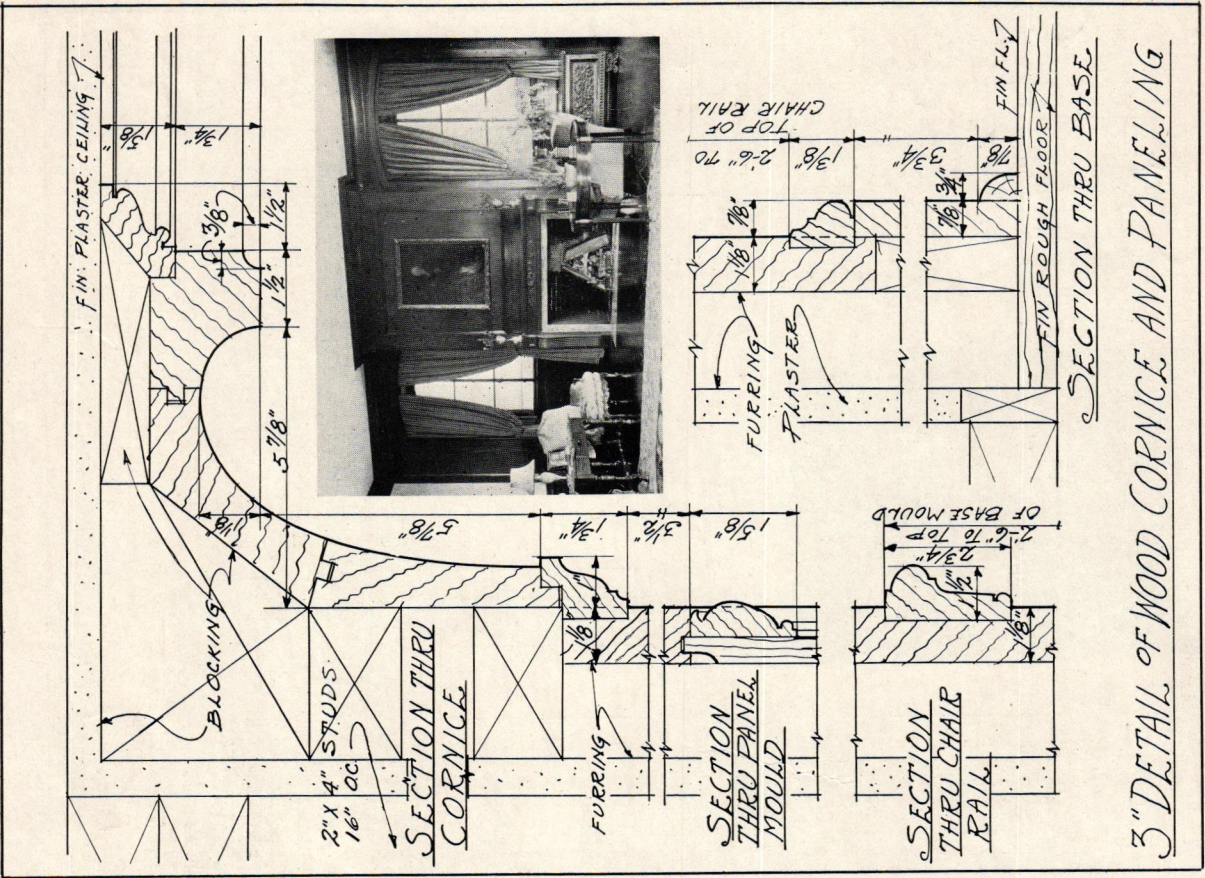

Photo by Tebbs & Knell

RESIDENCE OF F. E. JOHNSON, ESQ., PEAPACK, NEW JERSEY

Hyde and Shepherd, Architects