

# COLUMNS

Vol., 2 No. 10

American Institute of Architects, Pittsburgh Chapter

November 1988

## CITY ARCHITECTS WIN TOP HONORS FROM PSA

A Pittsburgh architect and two Pittsburgh firms were honored by the Pennsylvania Society of Architects at the ARCON '88 awards ceremony in September.

David Lewis, FAIA, Chairperson of UDA Architects, received the PSA's highest award, the Medal of Distinction in recognition of his "contributions to architecture that transcend local boundaries and have benefited the profession and citizens of the Commonwealth." At right, PSA President Stephen George, FAIA, presents Lewis with the award. The Medal of Distinction, now in its second year, is chosen by a two-thirds majority vote by the PSA Board.

Also presented at the ARCON ceremony was the 1988 PSA Silver Medal given to Bohlin Powell Larkin Cywinski and Burt Hill Kosar Rittelmann Associates for their joint venture on the Software Engineering Institute (far right) at Carnegie Mellon University. The five story structure was developed by the RIDC at a cost of \$21.5 million. Robert S. Pfaffmann, AIA was project architect; Peter Bohlin, AIA and Dick Rittelmann, FAIA were Principals in charge of Design and Technical, respectively.

Three Chicago architects juried the Silver Medal Award: Adrian Smith, FAIA

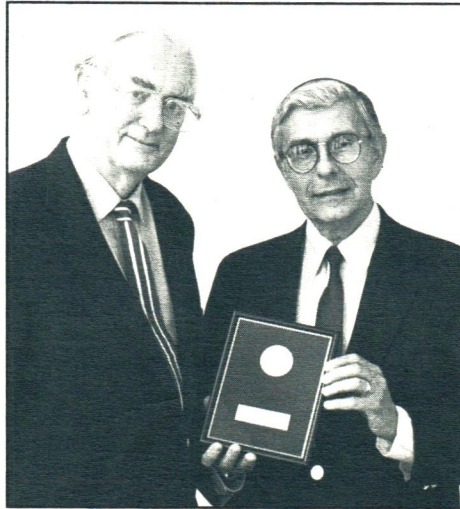

of Skidmore, Owings and Merrill; Jim Nagle, FAIA, of Nagle Hartray & Associates; and Paul G. Florian, AIA of Florian-Wierzbowski. Jurors described the Software Engineering Institute as elegant, modern and original, "a contemporary building that feels good, with both Classic and Gothic around it." They commented further that the building exhibits "a wonderful use of materials combined in such

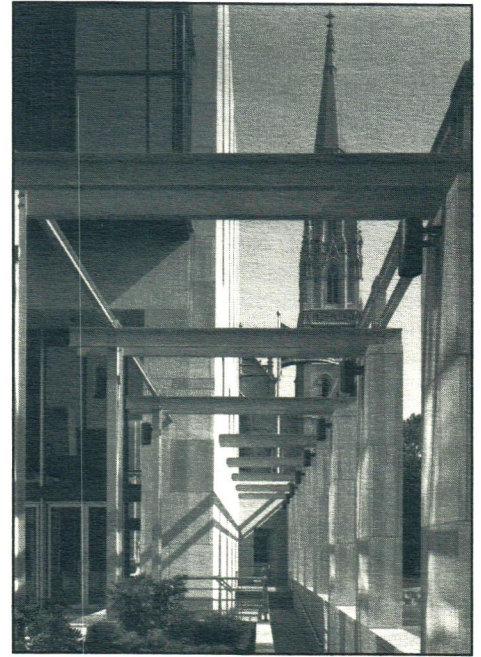

a way that it gives a breakdown in scale."

In addition to the Silver Medal, the Software Engineering Institute received a 1988 Design Award from the Pittsburgh Chapter AIA. (See center spread.)



*James Roddey, center, with student participants in R/UDAT symposium, "The Community, the River and Tomorrow." In the foreground, a model of the Homestead Works.*

## Roddey, Berger Open Steel Valley Symposium

The Pittsburgh Chapter AIA has formed a consortium with the Steel Valley School District and New Heritage Inc. to sponsor an outreach program for high school students. Twelve juniors and seniors will meet monthly in a full-day symposium with local architects, planners and community organizers. The symposium, *The Community, the River and Tomorrow*, will include topics on history, demographics, economic development, neighborhood design, government, politics and education. The goal is to develop students' leadership skills, problem solving strategies, community awareness and an understanding of urban planning.

(continued on page 4)

## BREAKING GROUND

### Kudos

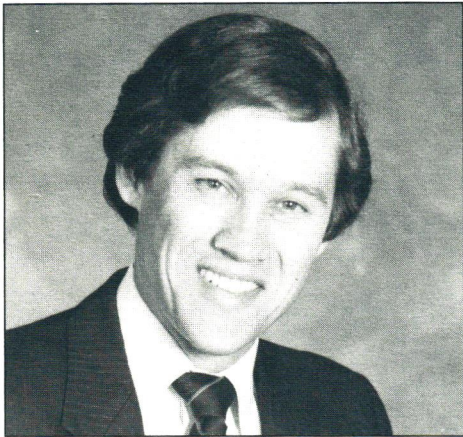

Pittsburgh Architect **Robert Dale Lynch, AIA**, long an advocate of creative design for the handicapped, has been named to the American National Standard Institute Committee on Accessibility. This group of 50 national representatives assists the Institute in reaching their goals to develop a body of knowledge about accessibility and to promote the incorporation of ANSI Standards into national building codes.

In a recent cover story, The Pennsylvania Rehabilitation Association News congratulated Bob for his "courage and conviction... his enthusiasm and passion" in working to-

wards an environment for all people. Along with his work with ANSI, Bob has also been instrumental in the introduction and promotion of S.B. 730, the Handicapped Accessibility Act, which sets the standards and direction for accessibility in our state.



The Department of Housing and Urban Development recently presented its 1988 Award to **Holmes Place** (above) for excellence as a demonstration project of affordable housing. Recipients include **Quick Ledewitz, Architects**; the Oakland Planning and Development Corporation, developer; Ryan Homes, contractor; The Pittsburgh Urban Re-

development Authority and Mayor Sophie Masloff. The planning team worked for a year to design the 64-unit complex. They reduced construction costs by using panelized or semi-manufactured materials; by creating a high-density development; by using economical designs and materials for driveways and paving; and by installing all utilities in a single trench at the same time. The development is a mixture of subsidized and market rate houses with four units designed for wheelchair access.

Not only has **Jim Johnson, AIA**, Johnson Schmidt and Associates, joined the Pittsburgh Chapter Board of Directors, he has joined the city's "10 Best Dressed" list. Congratulations!

### Transitions

**Bohlin Powell Larkin Cywinski** has moved into newly renovated quarters on the 13th floor of the Bank Tower, 307 Fourth Avenue, 15222.

Also unpacking are the **Facility Planning and Design Groups of Michael Baker Jr., Inc.**, now located at 420 Rouser Road, Coraopolis, 15108. New telephone number for PSA Board Member, George Ehringer, AIA, for First Vice President, Kent Edwards, AIA, and their colleagues is 269-6200.

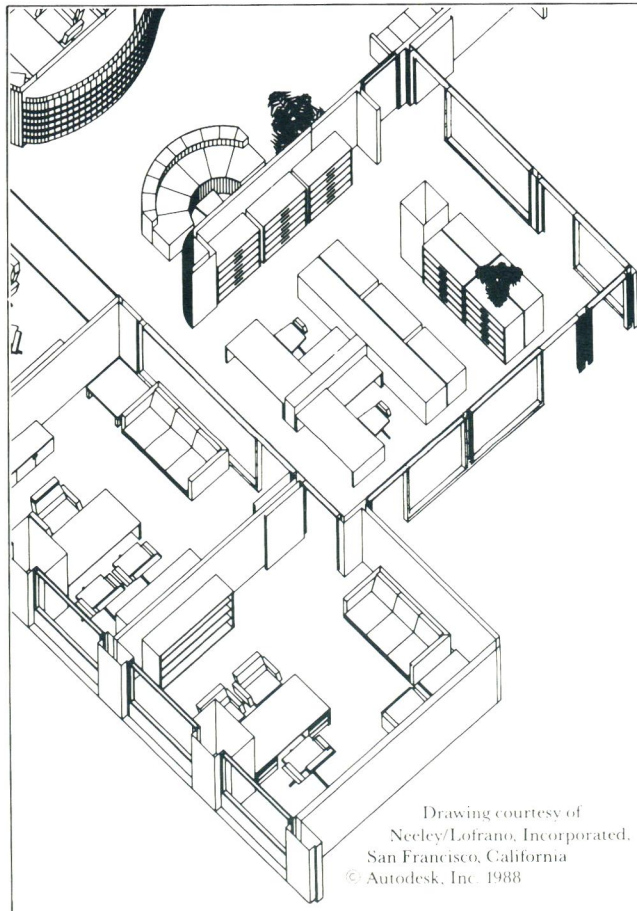

Drawing courtesy of  
Necley/Lofrano, Incorporated.  
San Francisco, California  
© Autodesk, Inc. 1988

## A NEW PERSPECTIVE ON ARCHITECTURAL DESIGN

AutoCAD AEC Architectural now taps the full power of 3D to streamline the process of design development, floor plan preparation, and presentation. Automatically maintain accurate dimensioning and area information as you design. Move from 2D bubble diagrams and floor plans to 3D models with a few key-strokes. Develop contract documents automatically using the AutoCAD AEC architectural database functions. Use the dynamic combination of AutoCAD AEC Architectural and AutoShade™ to create attractive full-color renderings. Compatible with most PC-DOS and MS-DOS micro-computers. **AutoCAD AEC Architectural**, a new standard for design professionals from the people who create the world's most popular computer-aided design software.

 **AutoCAD AEC™**  
Architectural

 **Cherrington Corporate Center**  
Building Two  
1700 Beaver Grade Road  
Pittsburgh, PA 15108-3104  
412/262-4430

Western Pa.'s largest supplier of CAD products and services

## Here and There

**Williams Trebilcock Whitehead** has teamed up with Ellerbe Becket, Inc. to design new office and laboratory space for Eye & Ear Institute of Pittsburgh. The \$1.9 million addition will be built on the top floor of the Lothrop and Darragh parking garage. Expected completion date is March 1989.

WTW President **G. Thomas Williams** has been named to a 14-member task force to develop a long range plan for Old Economy Village, a six-acre historic site near Ambridge in Beaver County.

The firm welcomes its newest member, Clifford W. Holasek, a graduate of Oklahoma State University School of Architecture.

**Kingsland Scott Bauer Havekotte Architects** has been selected by MEDRAD, Inc. to design a new \$19.5 million research, development and manufacturing headquarters. The project will consolidate the company's medical products operations which are currently located in RIDC Park and Indianola. The facility could be operational as early as July, 1992.

KSBH has also recently hired four new graduate architects: John A. Cullen, Thomas Pierce, Jacob J. Raketich, and Kevin Turkall.

**Hayes Large Suckling Fruth & Wedge Architects** announces the first phase of a \$53 million construction and renovation program at the Veterans Administration's Chronic Care Division in Aspinwall. Included in the project is a new 400-bed hospital with 160 intermediate care beds and 240 long-term care beds.

Several Sigma/Arris Cadd users have formed the **Three Rivers Arris User's Group**, an independent association which meets monthly to discuss and test user applications and new products from Arris. Membership is open to license holders of Sigma/Arris software and students. For more information, call User Group President **Gary Moshier AIA**, Kingsland Scott Bauer Havekotte Architects, at 231-1500.

## Call For Entries

Think you'd like to try your hand at poster design? Get your creative juices flowing for the 1989 **Palladian Ball Poster Contest** sponsored by the **Community Design Center of Pittsburgh**. Architects, art students and design professionals are invited to create a poster design for this year's Venetian Carnevale theme, *The Stones of Venice*.

In addition to a \$100 cash prize, winners will receive two tickets to the Ball (where they will be honored and their poster incorporated into the evening's festivities) and a Gallery Showing at the Mendelson Gallery in

Shadyside. Winners will be announced in February prior to the March 18 Ball at the Westin William Penn.

Each presentation must be a photographically reproducible two-color poster, 19"x 25" in size. The following phrases must be included on the poster: *The Stones of Venice, Palladian Ball 1989, and Community Design Center of Pittsburgh*. **Although the contest registration officially closed on November 1, the deadline has been extended to November 8 for COLUMNS readers.** Registration is \$10 or \$5 for students. Make checks payable to CDC of Pittsburgh. Final artwork is due by December 16 and must be sent to Lynn Manion, Director, Community Design Center of Pittsburgh, 470 Landmarks Building, One Station Square, Pittsburgh, PA 15219. For more information, contact Lynn at 391-4144.

**The Pennsylvania Veterans' Memorial Commission** is sponsoring a competition for the design and construction of a memorial to Pennsylvania Veterans of all wars to be located at Indiantown Gap National Cemetery in Pennsylvania. For complete registration materials, contact Joseph R. Chelan, Pennsylvania Veterans Memorial Commission, c/o Bureau for Veterans Affairs, Fort Indiantown Gap, Annville, PA. 17003, (717) 865-8901. Entry deadline is November 30.

## Business Briefs



Herman Miller, Inc. has established a major local presence with the opening of **Office Pavilion/Rymaur, Inc.**, (formerly Spectrum Corp.) in the Century Building, 130 Seventh Street, downtown. An independent, locally owned dealership and showroom, Office Pavilion provides daily access to the manufacturer through a computer-linked national service network. For more information call Jim Zollner or Ron Gualtieri, 642-2230.

**Dillon Business Furniture** has introduced a new line of wood systems office furniture from SMED Manufacturing. The modular pieces are mass produced yet retain all the features of high quality architectural woodwork with features such as enhanced storage capacity, custom finishes and custom components. SMED corporate policy guarantees catalogue deliveries in 4 weeks or less.



## Franklin Interiors

Creative Office Environments

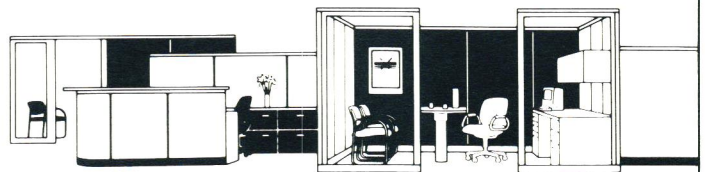

10th & Bingham St. Pittsburgh, PA 15203 381-2233

*Symposium (Continued from page 1)*

Keynote Speaker James Roddey opened the September symposium. Roddey, former Chairman of the Board of the Port Authority Transit, currently works to encourage entrepreneurial enterprises in Western Pennsylvania. The focus of the September session was Leadership. According to Raymond Supak, Steel Valley High School Principal, Roddey epitomizes the leadership possible when one individual's efforts benefit the entire community. He characterizes Roddey as "an excellent role model for the students, the future leaders of the Mon Valley." Roddey challenged students to think about leadership by asking students what leaders have in common. The answer, "followers," led to a lively discussion and more questions. He encouraged students to adopt his own personal secret to success, "to do what nobody else is willing to do, whatever that happens to be, spending extra time on school work, serving meals on wheels, running two more laps than you have to."

Marsha Berger, AIA, representing the Pittsburgh Chapter, spoke to students on the topic, Architectural Expressions of American Democracy (see box at right). In October, the symposium focused on history and Economic Geography, featuring speakers from the Historical Societies of Western Pennsylvania and of Homestead.

Students also took a private walking tour of the USX Edgar Thompson Works to examine first-hand an operating steel mill. In

November, Berger will return to guide the students on an architectural walking tour of downtown Pittsburgh.

Marsha Berger, AIA, an active member of the Urban Design Committee and of the Pittsburgh Chapter Board of Directors went back to school in September—but as a guest lecturer. Addressing Steel Valley high school students, she shared her vision of American architecture, which has resulted from more than a year of studying the question, "What is uniquely American about the American built environment?" She encouraged them to compare the tree-lined streets, wide front yards and green town squares of America to the closed off, private, walled cities of Europe. Our built environment, Berger believes, reflects the democratic ethic of individual freedom and participation in the political process. The extensive green spaces honor our country's history and growth, the urbanization of the wilderness. Comparing the focal points of European and American towns, the cathedral and the town hall, Berger suggested that these represent

central values of each region. Finally, she invited students to view Washington D.C., the nation's capital and its architecture as the ultimate example of political and architectural harmony. "At the center of the capital city, we have, not a cathedral, not a White House, but the Congress, the most representative arm of the government. The capital building is visible throughout the city, at the highest elevation. And when you enter, what lies beneath the dome of the highest building? An empty circle, where visitors seem compelled to walk, stand, look up. How representative of our history and political system—that anyone can stand in that circle—that at the center of power, stands the common man!" Berger concluded by suggesting to the students our society demands initiative and participation from all its citizens, and encouraged the students to study the issues in their own community in order to become leaders who can bring needed changes.

## **K. AMMONIA SUPPLY COMPANY**

**LIQUID & GAS AMMONIA • PRINTS TO THE TRADE • DIAZO SUPPLIES**

Responsive Turnaround • Pick-up & Delivery Service

**CALL 412 • 381-8700**

Hours: 8:30-5:00 Monday-Friday

**50 South 7th Street**

**Pittsburgh, PA 15203**