

Focus

Tapping Technology How to Build Teams and Win Clients



AIA Chicago

In This Issue: Call for Fellowship Nominations - 5 ■ Fastest-Growing Firms Rake in the Profits - 6 ■ Principals Speak Out on CAD - 15 ■ Emerging Visions: The Winners - 17 ■ Woodhouse Designs Altar for Jubilee 2000 - 18 ■ National AIA Diversity Conference Call for Papers - 19



3
Focus on Programs

5
President's Letter

6
News Briefs

10
Cover Story
Tapping Technology

15
Feature
*Principals Speak Out on
CAD: A Call to Action*

17
Feature
Emerging Visions 2000

18
Notebook

24
Calendar

March 2000

Editor

Susan Larson

Contributing Editor

Laurie McGovern Petersen

Focus Advisory Board

William Bradford, AIA
Howard Decker, FAIA
Deborah Doyle, AIA
James Jankowski, AIA
Edward Keegan, AIA
Laurie Petersen
Pat Rosenzweig
Alice Sinkevitch, Hon. AIA
Thomas Zurowski, AIA

AIA Chicago



A Chapter of The American
Institute of Architects

FOCUS (ISSN 1071-3700) Vol. 20, No. 3, is published monthly with a combined issue June/July, by AIA Chicago, 222 Merchandise Mart Plaza, Suite 1049, Chicago, Illinois 60654-1001. \$20 of each member's dues are allotted as a subscription. Periodicals postage paid at Chicago, Illinois. POSTMASTER: Send address changes to Focus, AIA Chicago, 222 Merchandise Mart Plaza, Suite 1049, Chicago, Illinois 60654-1001.

For advertising rates and schedules, call 312/670-7770.

© 2000 The American Institute of Architects Chicago. All rights reserved. Reproduction in whole or part without permission is strictly prohibited.

AIA Chicago on the Internet: www.aiachicago.org
AIA Chicago e-mail: info@aiachicago.org

2000 Board of Directors

President

T. Gunny Harboe, AIA

President-Elect

Thomas Zurowski, AIA

Vice Presidents

Joseph Caprile, AIA
Randall Deutsch, AIA

Secretary

Jonathan Fischel, AIA

Treasurer

Dave Urschel, AIA

Directors

Raymond Clark, AIA
Ellen Bailey Dickson, AIA
Kevin Hall, AIA
Philip Craig Johnson, AIA
James E. Prendergast, AIA

AIA Regional Director

Holly Gerberding, AIA
Lawrence Livergood, AIA

AIA Illinois Director

W. Stephen Saunders, AIA

Associate Director

Susan Campbell, Assoc. AIA

Professional Affiliate Director

Eric Singer

Past President

James Jankowski, AIA

2000 AIA Illinois Delegates

William Bradford, AIA
Thomas Braham, AIA
Hill Burgess, AIA
Deborah Doyle, AIA
Arthur Salzman, AIA
W. Stephen Saunders, AIA
Peter Schlossman, AIA (Alternate)
Lee Weintraub, AIA (Alternate)
William Worn, AIA
Robert E. Woodworth Jr., AIA

2000 Professional Interest Areas

Corporate Architects
Laura Horstman, AIA

Design
David Brininstool, AIA

Environment
Michelle Halle Stern, AIA

Health
Robert Carlton, AIA

Historic Resources
Thomas Gentry, Assoc. AIA

Housing
Margaret Cervantes, AIA

Information Technology
Kristine Fallon, FAIA

Interiors

Vito Lotta, AIA

Office Practice

Lisa Willis-Brown

Planning and Urban Affairs

Kyle Benkert, AIA

Technical Issues

Christopher Chwedyk, AIA

Young Architects

Helen Tsatsos, Assoc. AIA

Chapter Staff

Executive Director

Alice Sinkevitch, Hon. AIA

**Membership Coordinator/
Assistant to the Director**

Jamie Juliano

Program Director

Joan Pomaranc

Communications Director

Susan Larson

Financial Manager

Crystal Gagler

Public Information Receptionist

Nichole Brown

Documents Clerk

Barbara Homziuk

Cover image: ImageFiction's computer rendering of 191 N. Wacker by Kohn Pedersen Fox Associates PC

**Meet the Planners:
Kevin Brubaker**



*Wednesday, March 8, 12:00 noon
AIA Chicago
Sponsor: Planning & Urban Affairs PIA*

Kevin Brubaker, high-speed rail project manager and director of operations for the Environmental Law and Policy Center, will discuss the influence of transportation on the form of the Chicago. Bring your lunch; beverages provided. 1LU/1HSW

REITs 2000 and Beyond



*Thursday, March 9, 5:30 p.m.
AIA Chicago
Sponsor: Corporate Architects PIA*

Paul Fisher, CFO and general counsel of Centerpoint Properties, discusses the current status of Real Estate Investment Trusts (REITs) in the Midwest. What are the characteristics of REIT deals? How do architects fit in? How do these trends affect corporate real estate development? 1.5 LU

Tour: Northfield Block Plant



*Saturday, March 11, 9:00 a.m.
The Merchandise Mart (south side)
Sponsor: Young Architects PIA*



The International Masonry Institute will host a tour of the largest concrete masonry manufacturing plant in the area. See how concrete masonry is produced, from grinding the aggregate and weigh-batching raw materials to molding blocks and finishing. The bus will return by 12:15 p.m. 1.5 LU/1.5 HSW

Recent Changes to CES

As of January 1, AIA members are required to complete 18 learning units (LU) with eight health, safety and welfare hours per year. This is a change from the previous requirement of 36 LU.

An Energy Code for Chicago



*Tuesday, March 21, 5:30 p.m.
AIA Chicago
Sponsor: Environment PIA*

An energy code based largely on the International Energy Conservation Code is to be proposed for the revised Chicago Building Code. What will it mean for architects? 1.5 LU/1.5 HSW

Interested in Design/Build?

*Wednesday, March 29, 5:30 p.m.
OWP&P, 111 W. Washington*

If you would like to participate in a new Design/Build PIA, join the following members for this inaugural meeting: Bruce Ream, AIA, Hill Burgess, AIA, Len Skiba, AIA, Mark Friedlander, Andy Koglin, AIA, Wayne Marth, AIA, Mark Downey, AIA, Phil Zinni, AIA, Cliff Bedar, AIA and Mike Behm, AIA.

CAD for Principals

*Tuesday, April 4, 5:30 p.m.
AIA Chicago
Sponsor: Information Technology PIA*

Panelist will discuss the work of the CAD for Principals Council, which has been analyzing the current state of CAD and related technologies to define what they expect from the next generation software. (See story, page 15)

New Members Breakfast

*Wednesday, April 12, 7:45 a.m.
AIA Chicago
Sponsor: Board of Directors*

Representatives from AIA Chicago's board of directors will host a breakfast for new members, answering questions about the organization and the benefits and resources each level provides. Please RSVP by Monday, April 10.



Sign Me Up!

- 3/8 Meet the Planners: Kevin Brubaker
- 3/9 REITs 2000 and Beyond
- 3/11 Tour: Northfield Block Plant
- 3/21 An Energy Code for Chicago
- 3/29 Interested in Design/Build?
- 4/4 CAD for Principals
- 4/12 New Members Breakfast

Name _____

Office _____

Address _____

City _____

Phone _____

Fax _____

All programs listed above are free or as noted for AIA Chicago members. Non-members will be charged \$10 per program or as noted.

Method of Payment

- Check
- American Express Visa MasterCard

Credit Card No. _____

Expiration Date _____

Name on Card _____

Signature _____

Fax to:
AIA Chicago
Fax 312/670-2422



They All Got Jobs.

Have you looked around lately? It appears as though everyone has a job. For architects and other design professionals, unemployment is at an all time low. Every firm is hiring, so how can you get your name and resume in front of the right hiring manager?

The answer is CFA. Our feelers are always out, especially in this market. Over the past 15 years we've built a job database unequalled anywhere in the USA. Since 1984, CFA has successfully introduced candidates and firms more than 20,000 times.

Come to a CFA office for a complete and comprehensive portfolio review and CAD skills evaluation. We will refer you to one of our award-winning

clients to perform per-project consulting services or, if you prefer, CFA will help find you a permanent position at the firm of your choice.

"CFA makes suitable matches through careful listening and thorough skill evaluations. As a result of their professionalism I was placed successfully both as a consultant and then as a permanent employee", Brooks Slocum, AIA, HOK employee.

CFA's job placement counselors have years of experience in the staffing industry and specialize in the field of architecture and design. Let CFA help you chart a path that will satisfy your professional career goals. Act now -- schedule your interview with CFA and get started on your new job today.



For more information contact Consulting for Architects, Inc. at 312-345-1700 or on-line at www.cons4arch.com

Leadership in the Design Century



In January, I attended Grassroots 2000, the AIA's annual leadership and legislative conference in Washington, D.C.

During a morning plenary session, Richard Farson, Ph.D., a psychologist at Western Behavioral Sciences Institute and a member of the AIA board of directors, predicted this would be the "Century of Design."

At first it is hard to believe this could be true. Isn't this the age of the Internet? Won't the new e-technologies dominate our professional and personal lives? How is it possible it will be a "Century of Design" led by architects and other designers?

Upon further reflection, Farson may be right. While it is true everything is changing at an incredible pace, there is still the need to build new buildings to house new businesses and an ever-expanding population. Architects are presented with an incredible opportunity. We will need to use the new technology not only in how we do our work, but also in incorporating it into the physical

reality we continue to create. This will take creativity, innovation, and above all leadership.

"By the end of the last century, we knew that we couldn't predict the future. But we can design it; we can build," Farson said, explaining the reason for entitling his talk, *Leadership in the Design Century*. "If civilization is going to survive, we will have to design it."

According to Farson, architects increasingly will serve as leaders of business and civic organizations because we are much better qualified than other professionals to advise organizations on how to collaborate. Architects need to appreciate the aesthetics of leadership — its gracefulness, humility, and compassion — not just its efficiency, he said.

And, that brings me to the point of this letter: a call for leaders.

To identify the best and broadest group of candidates for AIA Chicago leadership positions, I am asking members to suggest candidates for task forces, the board of directors, and Professional Interest Areas (PIA) steering committees. Self-nominations are encouraged.

As well, the Fellowship Committee soon will begin to consider a list of nominees for 2001 election to the College of Fellows. The FAIA distinction is one of the highest honors bestowed upon an architect. Fellowship recognizes the achievements of the architect as an individual and elevates him or her before the public and profession as a model architect who has made significant contributions to architecture and society. To be considered for the College of Fellows, an individual must have been an AIA member for at least 10 years.

List your suggestions for Chapter leadership or Fellowship consideration on the form provided and return it to AIA Chicago; or, e-mail Alice Sinkevitch at sinkevitcha@aiachicago.org.

T. Gunny Harboe, AIA
President



Call for Nominations for Fellowship and Chapter Leadership

Recommended nominee

To be considered for

Nominee's address

Nomination made by

Please complete and return this form by April 14 to AIA Chicago, 222 Merchandise Mart Plaza, Suite 1049, Chicago, IL 60654. FAX: 312/670-2422. E-mail: sinkevitcha@aiachicago.org

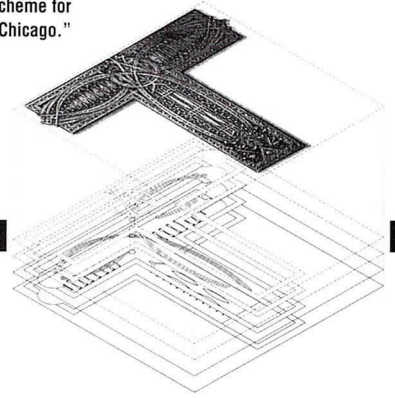

IIT Breaks Ground on McCormick Tribune Campus Center

Groundbreaking ceremonies will be held on March 9 on the campus of the Illinois Institute of Technology for the school's new campus center designed by Rem Koolhaas of The Office for Metropolitan Architecture with Holabird & Root LLP. Completion is expected in fall 2001.

Fastest-Growing A/E/P Firms Rake in the Profits

The fastest-growing firms in the industry — average annual revenue and staff growth of more than 20 percent for the past three years — report higher profits than the total firm sample for all profit measures collected, according to the first-of-its-kind *Successful Firm Survey of A/E/P and Environmental*

Consulting Firms (Zweig White & Associates). Fast-growth firms earned a median net pre-tax, pre-bonus profit on net service revenues of 12.2 percent, greater than the overall industry median profitability of 8.9 percent (data for fiscal year 1998). The median net pre-tax, after-bonus profit on net service revenues of 6.7 percent among fast-growth firms was also higher than the overall median of 4.5 percent.

NCARB to Examine Current Practices in Architecture

The National Council of Architectural Registration Boards (NCARB) has begun an in-depth study of the profession to reveal trends and state-of-the-art practices in architecture. The results of the *Practice Analysis* will be analyzed to determine the knowledge, skills,

and abilities required to perform the functions of an architect. NCARB expects the information gathered will have a major impact on the areas tested by the Architect Registration Exam and will help schools shape their curriculums to better position students to enter the workforce.

Individuals from within the field of architecture and related professions participated in focus groups held over four days in Chicago and work observations are now being conducted in six firms recognized as leaders in specific aspects of the profession. A survey form will be mailed to 4,000 architects nationally this summer.

ARCHITEMPS, INC.®

ARCHITEMPS, INC.® -- the Architectural & Interior Design staffing specialists, serving greater metropolitan Chicago since 1986.

Quality staffing, service and solutions:

- Design/Production Drafters
- Facility Planners
- CAD Architects/Interior Designers
- Project Managers

Our billing includes all employer liability:

- Payroll Administration
- Employee Benefits
- Government Compliance
- State & Federal Tax Remittance
- Workers' Compensation Coverage

Architectural, interior design and facility planning personnel on a per-project basis. Customized employee leasing, permanent conversion and direct placement available. Call today for information on our staffing services or employment opportunities.

**ARCHITEMPS, INC.®
1050 North State Street
Chicago, Illinois 60610.1043**

**Tel: 312.649.0912
Fax: 312.649.1667
ARCHITEMPS@aol.com
<http://www.architemps.com>**

Results of the study are expected to be in draft stage by October and a final report published in early 2001. For more information on the *Practice Analysis*, contact Mark McKechnie at 202/783-6500.

Firms' Fun Designs the Feature of Fundraiser

The Epilepsy Foundation of Greater Chicago is sponsoring the fifth annual "Golf Around Chicago" from March 24 to April 23 at Navy Pier's Crystal Garden. Putt your way through an 18-hole miniature golf course designed and built by Chicago's top architects and construction companies. AIA Chicago members participating in this year's event include: Morris Architects/Planners, Eckenhoff Saunders Architects Inc., OWP&P, VOA, Lohan Associates, Otis Koglin Wilson, and Nagle Hartray Danker Kagan McKay. Tickets are \$6.25 for adults, \$5.25 for children under 12 on weekdays and \$6.75 for 18 holes or \$5.75 for nine holes on weekends (beginning at 5:00 p.m. on Friday).

Art Institute Begins Renovation of Original 1893 Building

In January, The Art Institute of Chicago began a major construction project to renovate and update various elements of its original Allerton Building on Michigan Avenue and Adams Street. The year-and-a-half long project includes completely reconstructing the front steps, renovating galleries in the Department of Prints and Drawings, and refurbishing Fullerton Auditorium, including the restoration of the Louis Comfort Tiffany dome.

During the construction project, the bronze lions at the entrance will be temporarily relocated while the 10,000 pound granite slabs that support the front steps are repaired.

The design architect for the project is Weese Langley Weese Architects, and the historical architect is Gilmore Franzen Architects, Inc. Restoration of the Tiffany dome is being completed by Botti Studio of Architectural Arts Inc. The general contractor is Walsh Special Projects Group.

Architects Will Feel Impact of New Chicago Electrical Code

Last month, the 2000 Chicago Electrical Code went into effect for projects submitted for permit review on or after February 7. Based on the 1999 National Electrical Code®, the new code incorporates important items from the previous Chicago Electrical Code. Holly Gerberding, AIA, assistant commissioner of the Department of Buildings, compiled this list of issues of importance to architects. For more information, contact Tim Arendt, chief electrical inspector, at 312/746-8054.

• **Emergency Systems.** By the year 2003, a non-utility (i.e. not ComEd) power source for emergency lighting and exit systems will be required in most buildings, both new and existing. Non-utility sources include diesel and natural gas generators, battery inverter systems, and unit battery fixtures. Building types affected by this provision include those with five or more dwelling units; commercial buildings of two stories or more; assembly and institutional occupancies; and high-rise buildings. In many cases, space may have to be reconfigured in existing buildings to accommodate this non-utility system equipment.

• **Metallic Raceway.** Metallic cable has an expanded use for extensions to receptacle outlets in dwellings under four stories and for flexible whips to ceiling fixtures in commercial occupancies. (This global requirement is consistent with the requirements in over 90 percent of surrounding cities, towns, villages and counties.)

• **Metal-Clad Cable (MC).** New wiring method to be permitted for extensions to receptacle outlets in existing dwellings and for flexible whips above ceilings and below raised floors, including "other space for

environmental air." (Efficient use of this product could lead to great savings in cost and labor for building owners.)

• **Other Space for Environmental Air** (Plenum Space). Removes the requirement for a specific Chicago review for fixtures above ceilings. Fixtures with tight seams and no openings to the air space listed by a testing laboratory are permitted.

• **Plenum Cable.** Plenum cable is prohibited. All wiring in environmental air space must be in metal raceway.

• **Sprinkler Protection.** Sprinklers will be permitted (but not required) in electrical closets, other than the main switchboard room, providing an increased level of protection to areas that are a known source of fires.

• **Low Voltage Lighting.** A new article will allow safe use of this popular lighting system.

• **Fire Alarm Systems.** Eliminates all of the outdated restrictive requirements that have made the design and installation of these life-saving systems nearly impossible when trying to use state-of-the-art equipment. (Will greatly enhance the use of systems and reduce installation costs.)

The Electric Association is producing a CD-ROM version of this ordinance. They can be reached at 630/724-0200.

Need Technical Support? Let Us Help.



Every design business could use a little technical support. Your CAD software should work for you and not the other way around. Join the many firms that use our HELP DESK services on a daily basis. We are helping our clients utilize the Autodesk, Kinetix, and ARCHIBUS families of products in ways they didn't realize were possible. Whether it's installing or customizing CAD software, getting the training they need, or trouble-shooting, our clients have come to rely on the CFA/HELP DESK. So don't go down with the ship - call the CFA/HELP DESK now and we'll make your problems our own. You can trust our knowledge and commitment.

For information and technical support services contact the Consulting for Architects, Inc. HELP DESK at 800-841-8848 or online at www.cons4arch.com

Looking for quality printing...*today?*

When you need printing right away, you no longer have to settle for a copy-shop product. InfoComm Electronic Prepress & Print uses the new technologies of digital and wide-format printing to skillfully produce quality results, in any quantity...quickly. At our River North location (open 24 hours), we can:

- Print your collateral materials (no quantity too small) in full color on a true offset printing press within *24 hours* (same day available).
- Provide transparencies and handouts for your presentations *overnight*—with color that blows those guys in the blue aprons away.
- Produce signage on a variety of stocks (glossy, matte, backlit, vinyl, you name it)—*next day*. Plus, we mount or finish your print as needed.

InfoComm has served Chicago's architectural community since 1987. As part of The Wagner Companies, we bring six generations of both conventional & digital printing experience to your projects. From design through printing, we can help.

To get an estimate on your next project, give our customer service representatives a call at 312.751.1220.

Clip this ad and send it in with your project and **SAVE 10%**. Total discount not to exceed \$100. Offer expires: 05/01/00
Offer number: AIA0300.



New

High-Speed Digital Blueprinting

High speed digital printing from scanned originals or prints and CADD plot files. Copies may be reversed (negative to positive) mirror imaged and stretched along with standard enlargements and reductions from 25% to 400%. We would prefer HP/GL2 files with pen weights set.

For more than 70 years, Mossner has provided the latest and fastest high-production equipment available. And now Chicago's first state-of-the-art Oce 9800 for Digital Blueprinting is here!

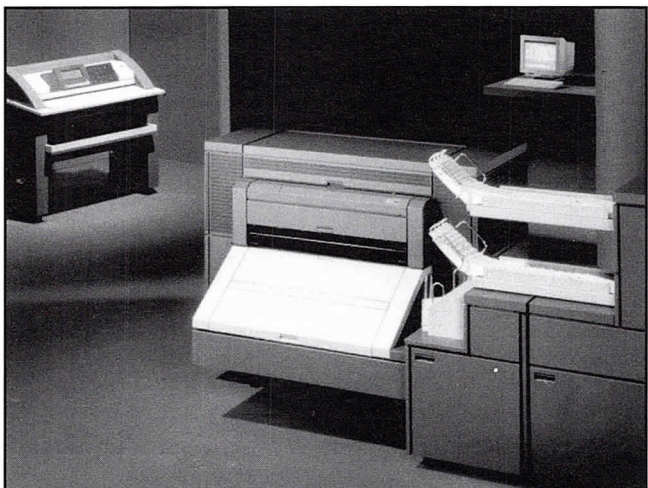

- **Pick-up and Delivery**
- **Fast Service**
- **Print Scanned Originals**
- **Print HP-GL, HP-GL/2, HPRTL, TIFF_{5.0}, CALS₁ Files**
- **Print Collated Sets Fast**

BOND PAPER DPB

Total Sq. Ft. per order	Price per Sq. Ft.
1 to 49	.50
50 to 74	.35
75 to 99	.25
100 to 199	.20
200 to 499	.19
500 to 999	.18
1000 to 1999	.17
over 2000	.15

Minimum Charge \$25.00
\$2.00 per scan, \$1.00 per CADD File

VELLUM PAPER DPV

Total Sq. Ft. per order	Price per Sq. Ft.
1 to 49	2.75
50 to 74	2.50
75 to 99	2.25
100 to 199	2.00
200 to 499	1.75
500 to 999	1.50
1000 to 1999	1.40
over 2000	1.35

Minimum Charge \$25.00
\$2.00 per scan, \$1.00 per CADD File

Mossner (312) 372-8600
 THE REPRODUCTION PEOPLE • LARGEST IN THE MIDWEST
 Mossner Building • 137 North Wabash at Randolph (across from Marshall Field's), Chicago, IL 60602

Tapping Technology

How to Build Teams and Win Clients

by Michael J. Bordenaro

Chicago architect Doug Garafalo, AIA has gained national notoriety for his use of advanced software and Internet communication in the design process. It may be surprising to learn it wasn't the desire to experiment

with new technology that drove Garafalo and two other practitioners to pursue the New York Presbyterian Church commission for which they are now receiving much attention.

"The desire to collaborate amongst friends was the driving factor in approaching the job," said Garafalo. "It wasn't because we had computer technology we wanted to use."

By enlisting the Internet, the four-person Garafalo Architects was able to join with two similarly small firms — Greg Lynn FORM in Hoboken, New Jersey and Michael McInturf Architects in Cincinnati. Only combined did they feel comfortable handling the 84,000-square-foot project.

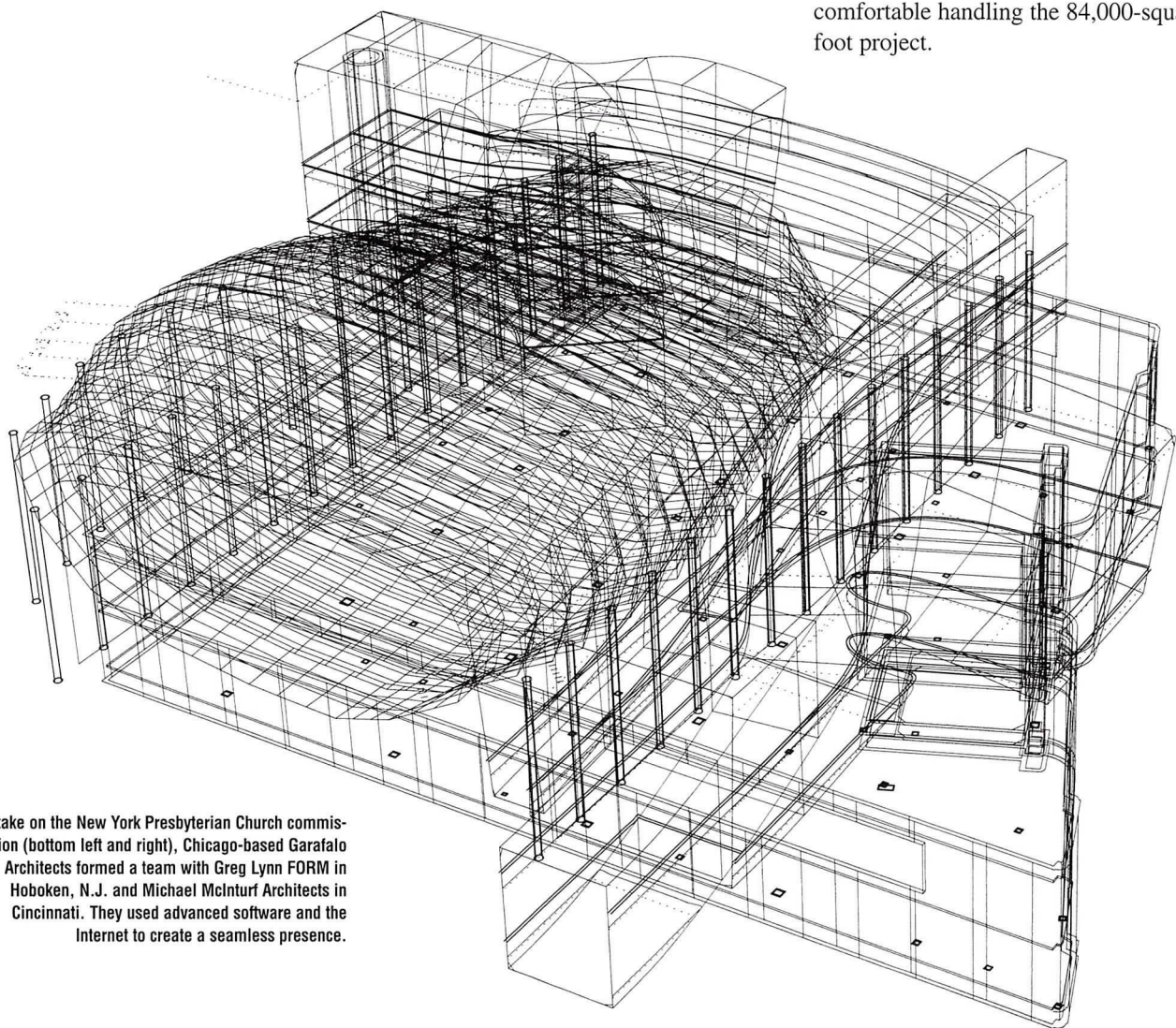

To take on the New York Presbyterian Church commission (bottom left and right), Chicago-based Garafalo Architects formed a team with Greg Lynn FORM in Hoboken, N.J. and Michael McInturf Architects in Cincinnati. They used advanced software and the Internet to create a seamless presence.

“We did not start off being savvy about CAD and the Internet; the church project helped make us savvy,” he said.

More and more, architects are using advanced software and the Web to meet the ever-increasing demands placed on the design process. Some are using new technology for client presentations. Others are investigating ways to spread the creation of complex electronic renderings among many parties in remote locations. And some firms, like Garafalo’s, are using it to design collaboratively on large projects they previously would have had little chance of winning.

The good news is that face-to-face human interaction, especially with clients, is not losing ground. And, no one person has to become an expert at every element of the ever-advancing technology.

Garafalo, Lynn and McInturf all were comfortable using computers and technology in new and different ways. For example, the team used sketch modeling and Alias/Wavefront animation software typically used for making movies. They

also chose to use Microstation as the CAD package because they felt it would better handle the complex geometry in their designs and in the animations. “I am good at ‘misusing’ software for something other than what it was intended,” Garafalo admitted.

“Microstation was known at the time for handling B-Splines and Non-Uniform Rational B-Splines (NURBS) surfaces. The animation programs rely heavily on high doses of calculus and those tend to manifest themselves in NURBS surfaces that are highly complex,” he explained.

“We used animation software because it more easily allowed us to show motion, which helped us express our contemporary view of architecture,” Garafalo said. “It’s not just about making ‘fly-throughs,’ it’s about using a program that is motion-based in the design process.”

He admits, however, that when his potential clients saw the animated renderings, “their eyes got real wide and that is when I knew we had the project.”

When the Internet Wasn’t Enough: Aerial video footage and a computerized fly-around of PPKS’ Luxor Locatie project in Rotterdam were transferred directly to videotape and flown to the client.

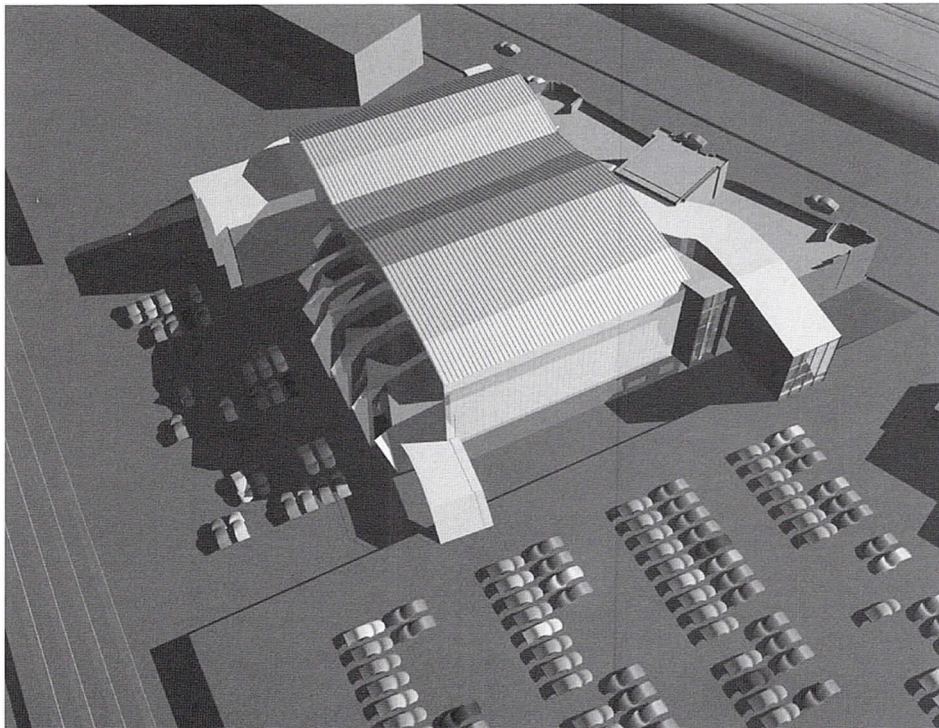

Craig Pryde, AIA is principal of the 17-person Perkins, Pryde, Kennedy & Steevensz Architects (PPKS) in Glen Ellyn. While Garafalo was comfortable working with advanced software, Pryde prefers to work with the Chicago-based architectural renderer ImageFiction to create the images that wow clients.

"I don't have the first-hand knowledge of how to use the detailed rendering software, but I understand the reasoning behind it," Pryde said. "We build the geometry in a rudimentary form which ImageFiction uses to create a finished rendering or 'fly-through.'"

Renderings are transferred either through PPKS' newly established File Transfer Protocol (FTP) area on the firm's Web site or through a third party project Web site. Pryde purchased the same color plotter that ImageFiction uses so that pen settings and plot configurations match as closely as possible. Pryde, whose firm is working on three projects totaling three million square feet in the Netherlands,

establishes procedures and tests so the plotters of his overseas associates can produce the same results.

"I don't have to know how to use the rendering software; the images are transferred in a format that allows them to be opened with PageMaker, Photoshop, or some other commonly used graphics programs," said Pryde, referring to a benefit of outsourcing detailed renderings.

This kind of service is creating a niche market for expert electronic architectural renderers. Eric Brightfield, founding principal of ImageFiction, said he is considered a part of the design team rather than a consultant.

"We work in the same way with all our clients, whether they're three blocks or 3,000 miles away," he said.

"Renderings approved by the architect in Connecticut at 4:05 p.m. can be in the developer's office in Atlanta by 4:10 p.m."

Brightfield knows the Internet and e-mail have made this kind of service possible, but he concedes that other modern conveniences — such as overnight courier services — play an important supporting role, especially when it's not feasible to transfer complex animation over the Internet and produce it locally. For example, PPKS is designing the largest high-rise in the Netherlands. The merger of actual aerial video footage shot from a helicopter circling the site and a computerized fly-around of the rendered building was transferred directly to videotape and flown to the client.

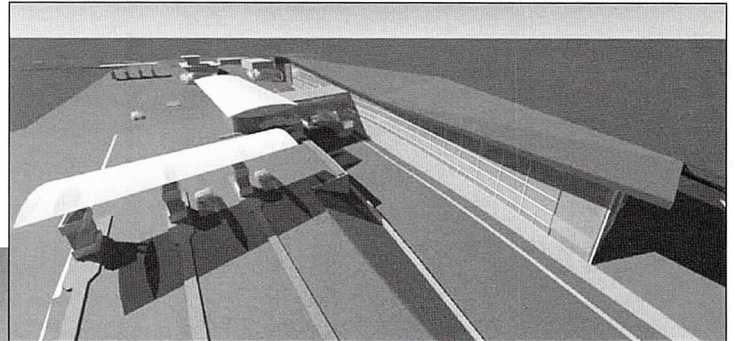

The computer animation used by Ross Barney + Jankowski Inc. to present their designs for a border station in Sault Sainte Marie, Mich. was part of the Material Evidence exhibit at the Museum of Contemporary Art.

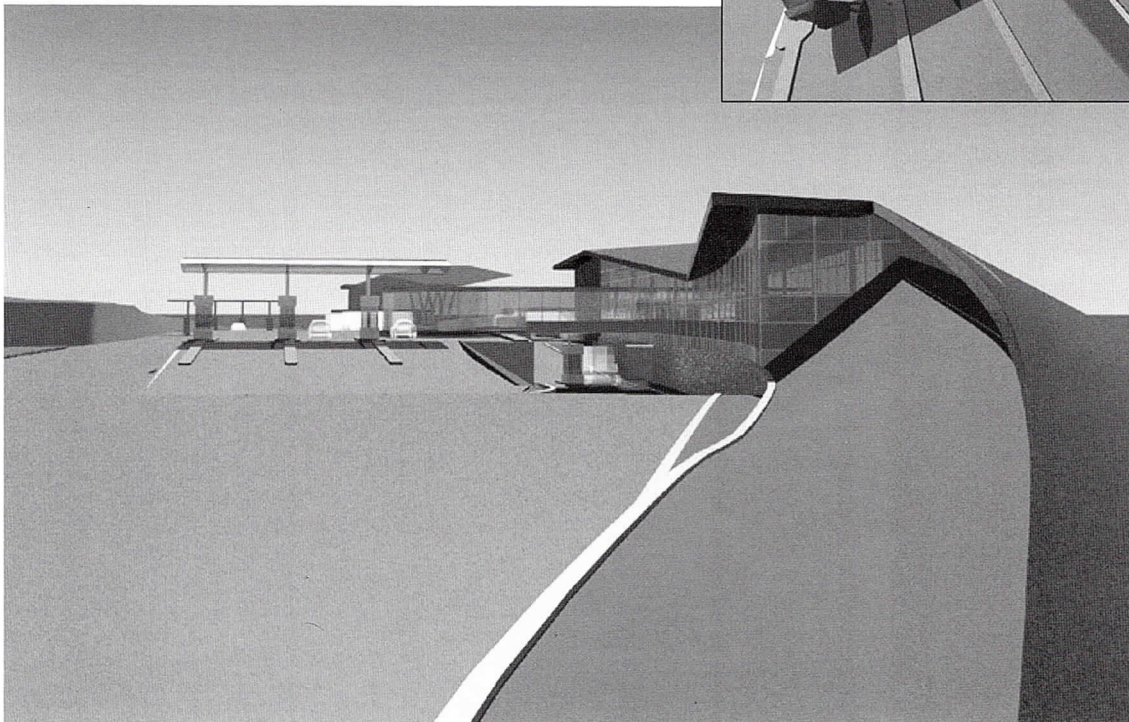

Northfield Block Company



Paver Series



Private Residence
St. Charles, Illinois
Landscape Architect: David Garcia
Installer: Villarreal Enterprises

Coventry Road Paver



French Country House
Lake Geneva, Wisconsin

Northfield Block Company

Manufactures
a wide variety
of concrete pavers.

Design choices
include Holland,
Wavy, Coventry Road
and Arrowhead™
Paver Series



Holland Paver

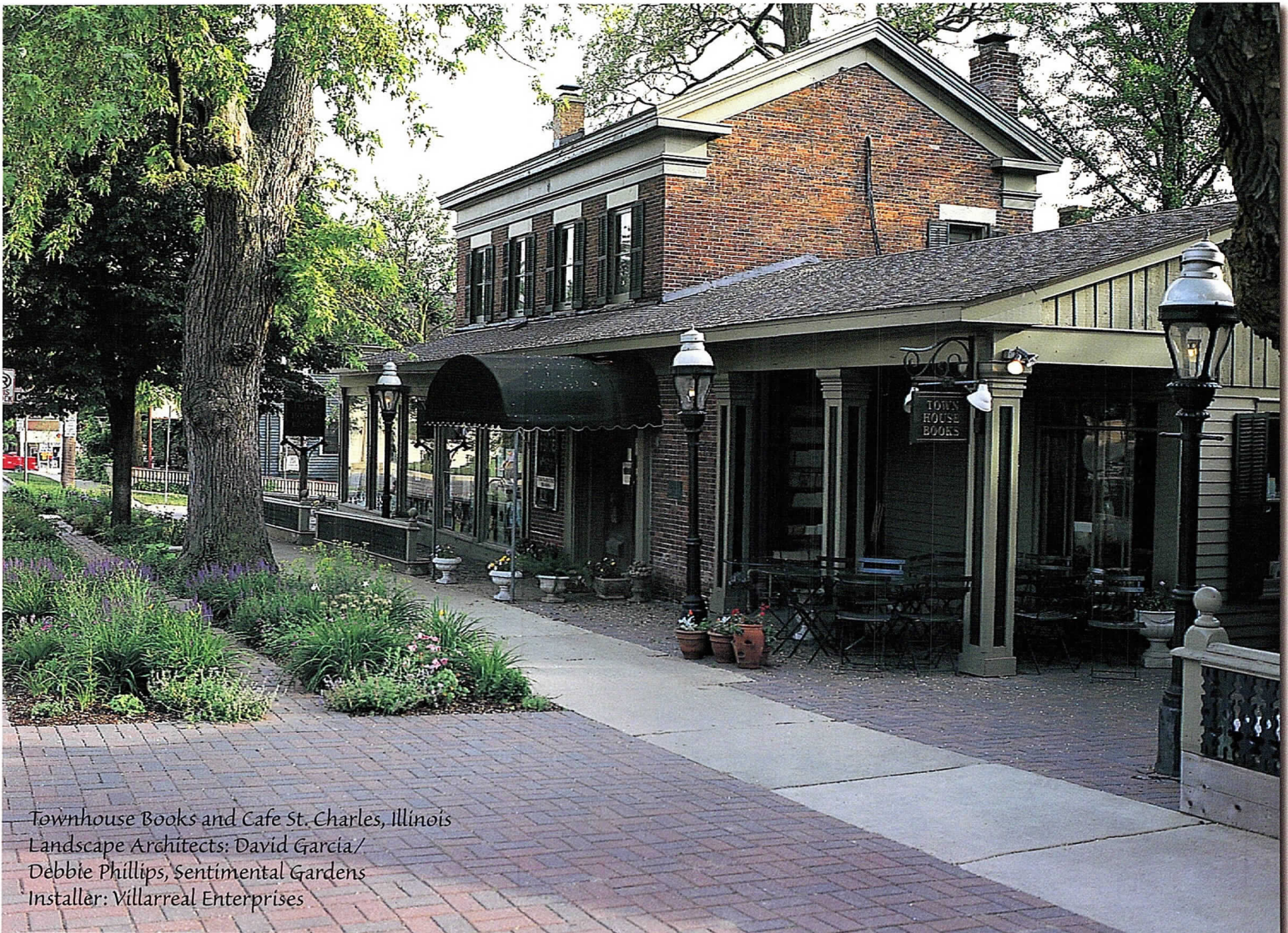

Townhouse Books and Cafe St. Charles, Illinois
Landscape Architects: David Garcia/
Debbie Phillips, Sentimental Gardens
Installer: Villarreal Enterprises



Our Red Charcoal Blend Holland Paver was used exclusively as the paving surface for the award winning Peck Farm Park in Geneva Illinois.



Peck Farm Park Geneva, Illinois
Architect: Mike Dixon
Landscape Architects: The Lannert Group /
The Kestrel Design Group
Civil Engineer: Environmental Systems Corporation
Installer: C. R. Schmidt Brick Paving
Landscape Contractors: Church Landscape, Inc./
R.Glass Landscape
(also Front and Rear Cover)

Paver Shapes, Colors and Specifications



Harvest

Holland Paver

4 1/4" x 8 1/2" x 2 3/8"
6.9 lbs.
400 Units/Pallet
4.08 Units/Square Foot



Charcoal Blend



Acorn



Red/Charcoal Blend



Solid Red

Eurostone™ and Arrowhead™ Paver

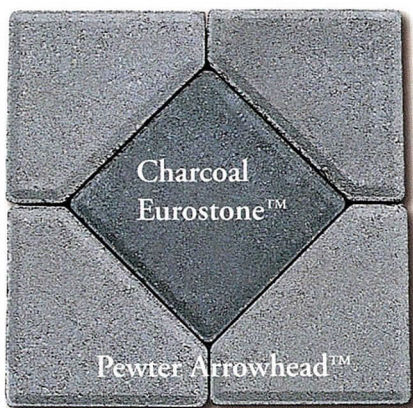

Eurostone™
6" x 6" x 2 1/4"
8 lbs. 360 Units/Pallet
4 Units/Square Foot



Arrowhead™
Approximately 6" x 1 5/8" x 2 1/4"
6 lbs. 450 Units/Pallet
5 Units/Square Foot

Paver Shapes, Colors and Specifications

Wavy Paver



4 7/8" x 8 15/16" x 2 3/8"
5.8 lbs.
400 Units/Pallet
4.62 Units/Square Foot
Available in all Holland colors

Coventry Road Paver



6" x 9" x 8cm
12 lbs. 192 Units/Pallet 2.66 Units/Square Foot

6" x 6" x 8cm
8 lbs. *224 Units/Pallet 4 Units/Square Foot

6" x 4 1/2" x 8cm
6 lbs. *112 Units/Pallet 5.33 Units/Square Foot

* 6" x 6" and 6" x 4 1/2" Coventry Road Pavers are on the same pallet
Available in all Holland colors except solid red

Paver Installation Instructions

- 1) Excavate the installation area to approximately 6" wider than project size. Install Paver Base to a finished thickness of 4" for patios and walkways, and 8" for driveways. Paver Base should be installed in 4" increments and thoroughly compacted.
- 2) Screed Play Sand to a 1" thickness over the compacted Paver Base.
- 3) Lay paving stones in the designed pattern with approximately 1/8" joints. If the designed pattern requires cutting, the pavers can be cut with a diamond masonry saw.
- 4) Install paver edger around the entire project according to the manufacturer's instructions.
- 5) Compact the installed pavers with a plate compactor in both directions with at least two passes.
- 6) Once compacted, spread Play Sand on the installation and sweep into joints. Compact again to ensure that all joints are completely full. Remove any remaining sand from on top of project.

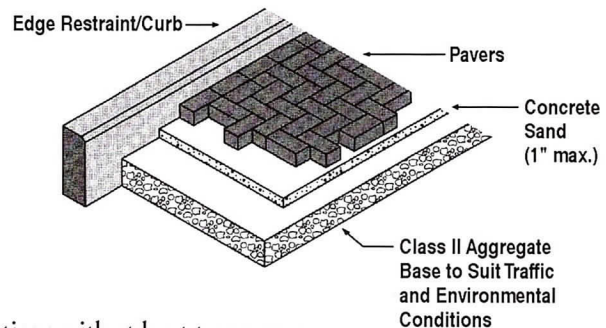



Distributed by:

Manufactured By:
Northfield Block Company
One Hunt Court
Mundelein, Illinois 60060
Ph: 847-816-9000 Fax: 847-816-9072
www.northfieldblock.com

The Art of Plastering

In addition to using Internet capabilities to help handle large international projects that would otherwise be nearly impossible for a mid-size firm, Pryde uses the newly created FTP area on his Web site to work with residential clients. "I can post a sketch in the FTP area and invite the client via e-mail to view it their home or office, so they can zoom in, print a detail, and call with a response," Pryde said.

John Fried, AIA, of Ross Barney + Jankowski Inc., said his firm is developing its approach to using Internet capabilities to the fullest.

"We have been using a lot of 3-D rendering and animation for projects and are currently giving clients CDs with files and plug-ins so they can view movies and panoramic views of their project," Fried said. "Eventually we will want to ... link to the client's Web site."

Kristine Fallon, FAIA agrees "the big challenge is the idea of merging advanced CAD technology with the project Web site concept to create collaborative modeling."

"This type of modeling is more than 2-D drawing or 3-D studio realization," said Fallon, chair of AIA Chicago's new Information Technology PIA. "This technology will let us consider, 'What if we make this room larger?'" This intelligent parametric building model that people would interact with on the Web will tell them how their change impacts issues such as distance to the fire exit, increased size of mechanical ducting, and its impact on structural issues.

"Suddenly we are not just looking at a drawing uploaded on the Web. The model is really talking to you as you make changes," Fallon said. "But, that is not going to happen this year."

Mike Bordenaro is a press and marketing consultant for architects and design professionals and can be reached at mjbwriter@compuserve.com.

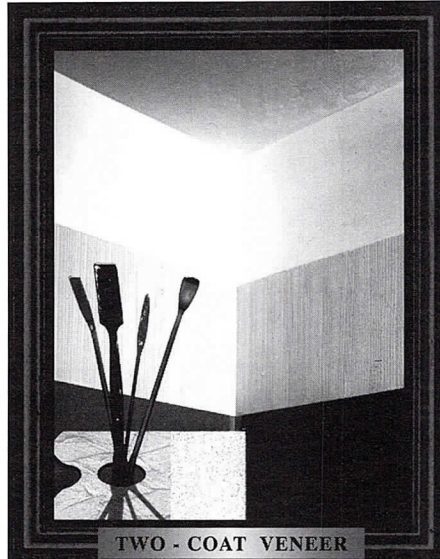

TWO - COAT VENEER

Spectacular walls.
Smooth...Textured...
Done the way you want them.
Hard and durable surfaces that
make paint and paper look
better, make redecorating
easier, make homes quieter.

**Plaster interiors are
more cost-effective than
you think.**

Call us for more information.



Chicago Plastering Institute
6547 N. Avondale Ave.
Chicago, Illinois 60631
773.774.4500
Fax. 773.774.5828



**Original
Design
Deserves
Original
Documents.**

Order today.

www.aiachicago.org

312/670-7770



**Premium
Interior Paints**
No Odor/No VOC

DURON
PAINTS & WALLCOVERINGS

Mike Wall
2200 Ogden Ave. #100
Lisle, IL 60653

630.493.1660 • 800.72DURON
• www.duron.com

90231 C-11

Protection Since 1952

Euclid Insurance Agencies has been providing insurance services to businesses since 1952. Our dedication to the complex field of insurance for design professionals enables us to give you the professional advice and tailored products you need. We have a unique understanding of the architectural and engineering clients we serve and the special coverages they require.

- Professional Liability, Workers Compensation, Disability, Office Package, Health Insurance, Estate Planning, and more
- Legal advice, seminars and continuing education programs
- Website access to risk management information
- AIA Chicago 401(k) and Profit Sharing Association Plan

EUCLID
INSURANCE AGENCIES®

977 Oaklawn Avenue • Elmhurst, IL 60126
Tel: (630) 833-1000 • Fax: (630) 833-1747

Principals Speak Out on CAD: A Call to Action

“I would measure the quality and support of current CAD software as an affliction on our industry.”

Since November 1999, the CAD for Principals Council has been working to analyze the current state of CAD and related technologies and to define what they expect from the next generation of CAD software. Kristine K. Fallon, FAIA, who leads the Council, prepared this article for Focus. On Tuesday, April 4 at 5:30 p.m. in the AIA Chicago office, she will host a panel discussion entitled, CAD for Principals. For more information, visit www.cadforprincipals.org.

In the early '80s when I worked in Skidmore Owings & Merrill's computer group, a design firm's minimum investment in CAD technology cost about \$500,000 (not adjusted for inflation). At that time, principals from all over the world traveled to Chicago to see how SOM was developing and using CAD technology to strategize their own CAD rollouts.

As prices for hardware and software dropped, so did the level of interest among principals. By the late 1990s, a real communication gap developed between the principals paying for the technology and the information technology staff who were evaluating, installing and supporting it. Principals were wondering, “Are we spending our technology budget on the right things?” Meanwhile, IT staff and CAD managers were saying, “I can't get my boss to tell me where computer technology could provide the greatest benefit to the bottom line. I need some guidance.”

Thanks to the CAD for Principals Council — an energetic and thoughtful group of principals from Chicago firms — and funding from Revit Technology Corp., the communication barrier is about to be broken.

Interviews conducted in late 1999 revealed the following frustrations with current CAD technology:

- Initial training hurdle
- Constant relearning of skills
- Isolation of experienced personnel from the process

- Staff tend to develop either computer skills or professional expertise, not both
- Difficulties monitoring project progress and catching mistakes
- Trouble coordinating/enforcing complicated CAD standards
- Problems getting output

Some principals are more optimistic about the state of the technology than others.

“I would measure the quality and support of current CAD software as an affliction on our industry,” said Jim Pritchett, AIA of Loeb Schlossman & Hackl.

Steve Saunders, AIA of Eckenhoff Saunders Architects believes computers have eased the cumbersome task of preparing complex documents and have improved our ability to envision a 3-D object and present it to the user. However, he's not quite satisfied and challenges future software products to “seamlessly link the architect's efforts to the industries that procure, assemble, construct, deliver, operate and occupy buildings.”

The CAD for Principals Council has agreed upon key requirements for the next generation CAD systems in these areas:

- Ease of use
- Software that works like an architect thinks
- Design and quality feedback
- Budget, schedule, performance controls
- Output and deliverables
- Industry-wide interoperability and electronic process

Members of the Council are: Robert Barnes, AIA, Knight Architects Engineers Planners Inc.; Leonard Clagett, AIA, DeStefano and Partners; David Gutierrez, AIA, McClier; Walter Hainsfurther III, AIA, Kurtz Associates Architects; Jack Hartray, FAIA, Nagle Hartray Danker Kagan McKay; Gregory Landahl, FAIA, Landahl Design Studio; James Pritchett, AIA, Loeb Schlossman & Hackl; Carol Ross Barney, FAIA, Ross Barney + Jankowski Inc.; Steve Santucci, AIA, McClier; Steve Saunders, AIA, Eckenhoff Saunders Architects Inc.; Deborah Sheehan, AIA, OWP&P; and Geoffrey Walters, AIA, OWP&P.

NeoCon[®]

World's Trade Fair 2000

The World's Trade Fair for Interior Design and Facilities Management

June 12-14, 2000 • The Merchandise Mart • Chicago, Illinois, USA

NeoCon[®] is the interior design and facilities management industries' most highly anticipated event of the year. Explore five concurrent shows — Buildings Show[®], Office Expo by OFDA, NEWHospitality, TechnoCon[™], and RE:focus. Discover thousands of the newest products and services for office, health care, hospitality, institutional and residential environments. Meet hundreds of key manufacturer's executives and choose from 110 CEU-accredited educational programs and 20 participating association forums. Attend numerous networking events and award programs.

For more information or to register on line, visit us at www.neocon.com or call 800/539-0310.



Trendway



Lees Commercial Carpet

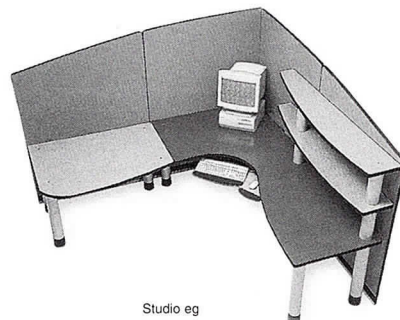

Studio eg



Boyd Lighting

Emerging Visions 2000

The Young Architects and Design PIAs, the Chicago Architectural Club, and Knoll Inc. in January sponsored the *Emerging Visions* portfolio competition. Out of 48 entries, the jury — Peter Exley, AIA; Eva Maddox, Assoc. AIA; and Ben Nicholson — chose three winners and two honorable mentions. Awards were given on February 17 during a reception and viewing at Knoll Inc. All entries will be on display at the Chicago Architecture Foundation, 224 S. Michigan Ave., from March 6 through April 28.

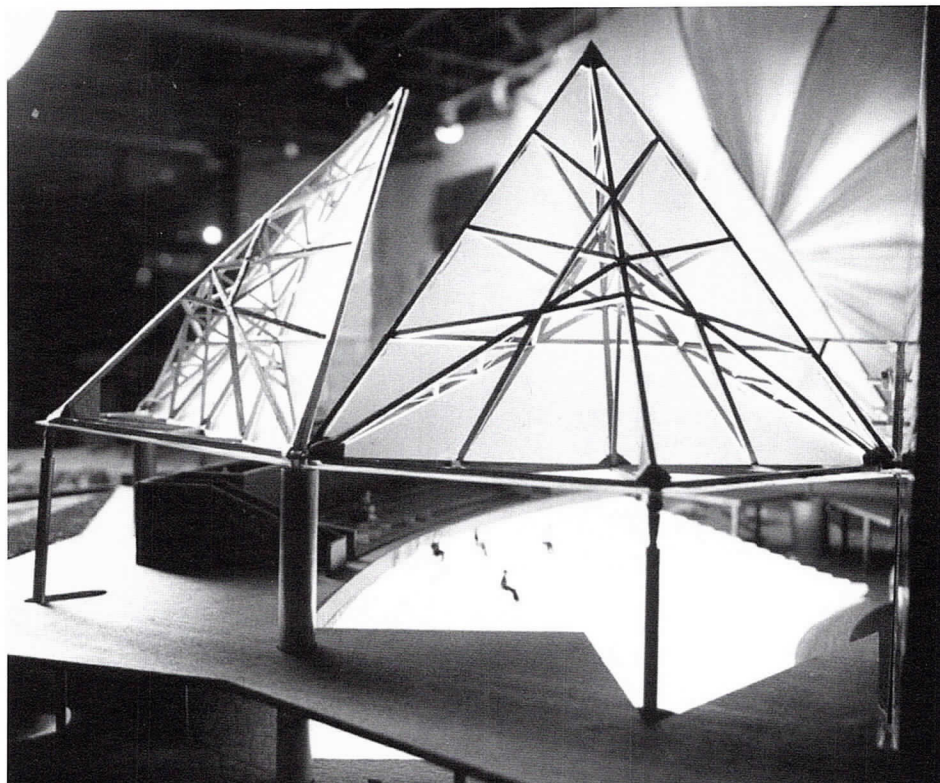

McCluskey Photography

First Place
(Top)

Jeanne Gang, AIA and Kathleen O'Donnell, AIA
Studio Gang/O'Donnell
Starlight Theatre

Second Place
(Bottom left)

Rusty Smith
School of the Art Institute
Re:making Things

Third Place
(Bottom Right)

Kevin Adkins
University of Illinois at Chicago
Artist/Student Co-Op

Honorable Mention
(Not pictured)

Dan Fouad, Assoc. AIA
Rugo/Raff Architects
Portfolio

Jeff Straesser, Assoc. AIA
Nagle Hartray Danker Kagan McKay
Regional Airport/Windfarm

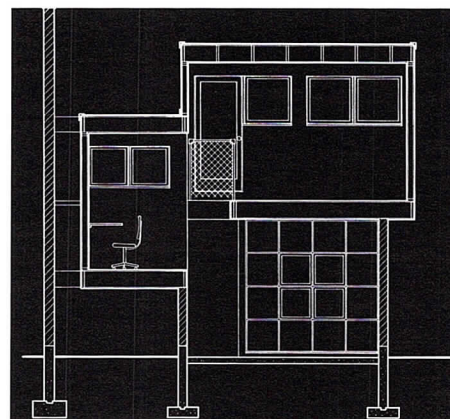
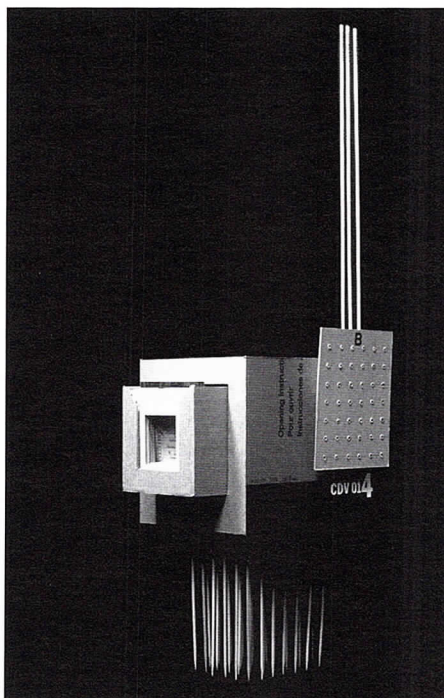

From left to right: Betsy Downs, AIA, Daniel Sullivan, AIA, and Gregory Surufka, AIA

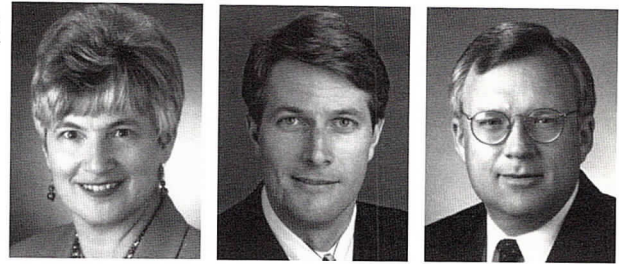

PEOPLE

Alan Arns, AIA has been named a principal of Dobrin Associates Ltd. Arns has been with the firm since 1998.

Gary Betts, AIA and **Jeffrey Liggett, AIA** have been promoted to principals at Loebel Schlossman & Hackl. In addition, **Yong Sang Choi, AIA**, **Mark Nichols, AIA** and **Robert Wootton, AIA** have been named senior associate principals, and **Steven Suski, AIA** has been appointed associate principal.

OWP&P recently elected three principals to the firm's board of directors. **Betsy Downs, AIA**, **Daniel Sullivan, AIA**, and **Gregory Surufka, AIA** are the first to be elected by a vote of all stockowners, bringing the total number of directors to 17, including three emeritus and two outside advisory directors.

Booth Hansen Associates has named **Will Gamble, AIA** a vice president of the firm.

Kurt K. Koentopp, AIA, a vice president of Solomon Cordwell Buenz & Associates, died on January 20 of a heart attack outside his North Side home. Koentopp, a graduate of the University of Illinois at Urbana-Champaign, worked on 35 W. Wacker Drive and the American Medical Association building and plaza at 515 N. State St. during his 30-year career.

Nia Architects Inc. has moved to 1130 S. Wabash Ave., Suite 200.

Jeffrey Reinke, AIA has joined the Chicago office of HOK as a senior associate and senior designer.

PROJECTS

David Woodhouse Architects is designing the sanctuary platform and altar for the Archdiocese of Chicago's Jubilee 2000 Celebration to be held at Soldier Field in June. The event, which recalls Chicago's 1926 International Eucharistic Congress, is

expected to draw more than 60,000 people, the largest gathering of Catholics here since Pope John Paul II's visit in 1979. The sanctuary's design is an interpretation of Da Vinci's *Last Supper* with 13 diaphanous canopies and towers representing Christ and the Apostles sharing the Communion meal.

The University of Evansville in Evansville, Indiana has begun construction of the \$16.9 million Koch Center for Science and Engineering. Designed by **Holabird & Root LLP**, the project includes the renovation of existing 1945 and 1977 facilities and adds new classrooms, laboratories, and a 100-seat auditorium. The estimated completion date is fall of 2002.

Mekus Studios Ltd., in association with Hammel Green & Abrahamson of Minneapolis, has been awarded the contract to renovate the Polk Street residence hall on the campus of the University of Illinois at Chicago. The \$2.3 million project will convert the six-story building from a traditional dorm-style living space to a more

PROJECT MANAGERS

Teng & Associates, Inc., a rapidly growing, Chicago-based, 370 plus person A/E firm is accepting applications for Project Managers for our Chicago, Orlando and Richmond offices. We are seeking energetic and entrepreneurial professionals with good people skills. Candidates must be licensed architects with a minimum of 10 years experience and ability to direct and manage a multi-disciplined team. Experience with client contact, contract negotiations and preparation of proposals required.

Teng & Associates Inc.
205 N. Michigan Ave.
Chicago, IL 60601
Fax No. 312-616-6067
hr@teng.com
EOE (M/F/H/V)

PETER MANEYSKI CONSTRUCTION, INC.

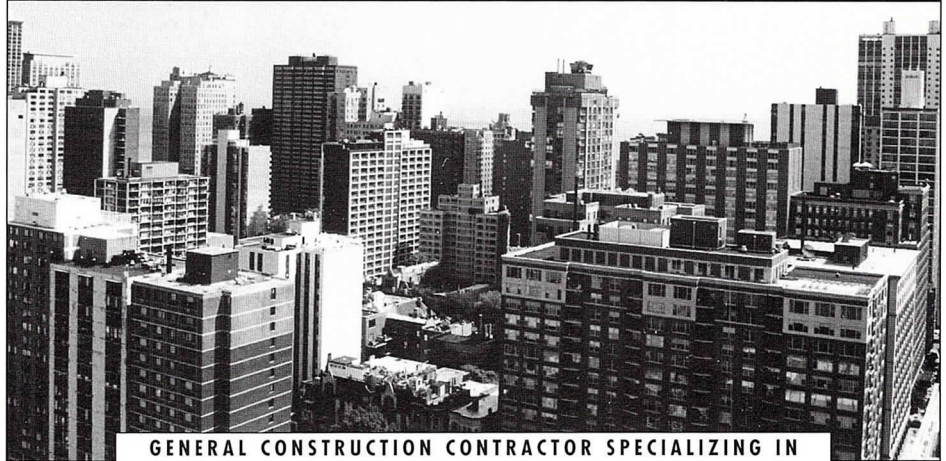

GENERAL CONSTRUCTION CONTRACTOR SPECIALIZING IN HIGH-RISE EXTERIOR MAINTENANCE AND REPAIR.

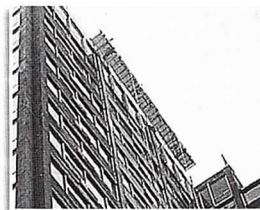

Peter Maneynski Construction Co. is a recommended Sika™ Contractor.

- Facade Inspection Equipment
- Leak Location Service
- Concrete Repair
- Tuckpointing
- Masonry Repair
- Lintel and Shelf Angle Replacement
- Balcony Restoration
- Waterproofing Systems
- Caulking
- Chemical Cleaning



1111 W. Webster St. Chicago, IL. 60614
773.348.6820 / ext. 237

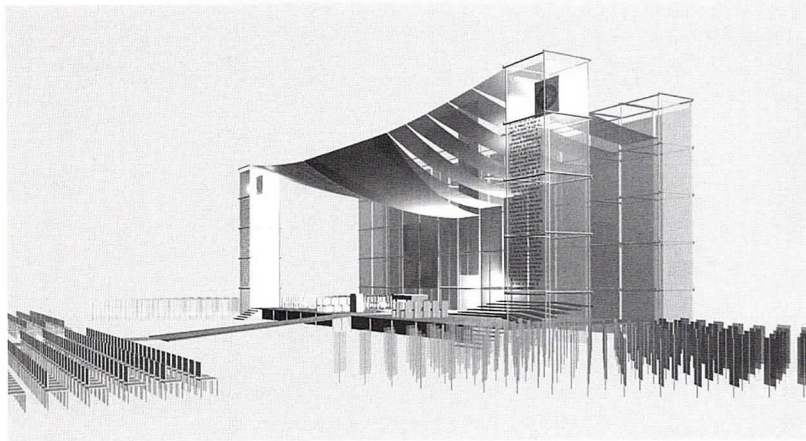

From left to right: David Woodhouse Architects' design for Jubilee 2000 and Johnson & Lee's award-winning Komed-Holman Health Center.

contemporary mix of apartment-style accommodations, suites and single-occupancy rooms. Mekus Studios also is designing the renovation and expansion of two North Shore churches, Winnetka Presbyterian Church and The Village Presbyterian Church in Northbrook.

Best Buy Co. has selected a partnership of Opus Architects & Engineers and Perkins & Will as architects for the company's new headquarters in Richfield, Minn. The project includes 1.5 million square feet of office space.

RTKL Associates Inc. has completed the design for two new buildings of a three-building campus devel-

oped by The Rubenstein Company LP in The Greens at Westfields complex near Dulles Airport. RTKL's scope of work on the project includes architecture and interior architecture. Originally masterplanned by RTKL in 1995, the Westfields development will eventually comprise a total of 770,000 square feet of office space.

Solomon Cordwell Buenz & Associates has completed the design of Corridors III, a 217,500-square-foot, seven-story corporate office building at The Corridors in Downers Grove. The Alter Group is developing the project. The typical tenant floor has approximately 32,000 rentable square feet and is laid out with a 30- by 40-foot grid structure.

AWARDS

Bailey Edward Design recently received a Merit Award from *Custom Home Building* magazine for the design of the Hauser Residence, a summer home in South Haven, Mich.

The Richard H. Driehaus Foundation honored three projects on February 8 for Architectural Excellence in Community Design. **Johnson & Lee Architects and Planners** took first place and a \$15,000 cash prize for their \$5.1 million, 24,000-square-foot Komed-Holman Health Center in the North Kenwood-Oakland community for Near North Health Service Corp. **Booth Hansen Associates** was the second place winner for the Republic Windows & Doors factory and headquarters on Goose Island. The facility was cited for setting a standard of design that is unrivaled among industrial plants downtown. Third place was given to CTE Engineers for the restoration of the recently reopened Jackson Park Pavilion.

www.teleport.com/~aiatrust

Insurance and Financial Programs for AIA Members

Health
Insurance

Disability

Life
Insurance

Retirement
Program

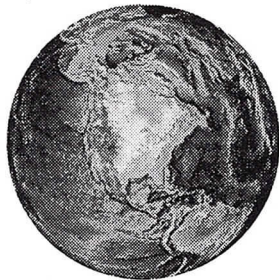

Small Firm Professional Liability

Business
Insurance

Automobile
Insurance

LegalLine
Insurance

Continuing
Education

What Are Architects Saying About Today's AIA Trust?*

96% say the AIA Trust is a valuable membership benefit.

94% of those most familiar with the Trust say the Trust's programs are a reason to belong to AIA.

3/4 of the participants in today's AIA Trust would recommend the program.

AIA Trust

Plan information is available 24 hours a day, toll-free at

1-800-255-8215

Visit e-Architect on www.aiaonline.com

Select Member Services

*AIA Trust Product Evaluation Study
Wiese Research Associates 1998

OWN A PIECE OF MIES

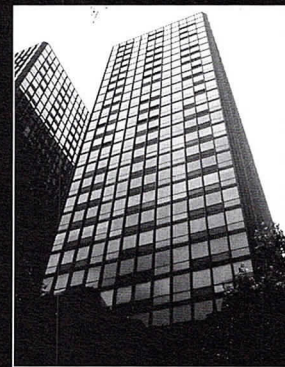

REPRESENTING ARCHITECTS AND
OTHER AESTHETICALLY-ORIENTED
BUYERS AND SELLERS OF
CHICAGO RESIDENTIAL PROPERTIES



SPECIALIZING IN THE BUILDINGS
OF MIES VAN DER ROHE

TRACY DILLARD
KOENIG & STREY, INC. □ 312.893.3557
TDILLARD@KOENIG-STREY.COM

Design: Lidia Varesco



CALLS FOR ENTRY

The American Institute of Architects' **Diversity Conference 2000** will be held in Chicago, August 4 through 6. Conference organizers have issued a call for papers and workshop proposals in two key areas: Diversity and Design and Business and Diversity. The submission deadline is March 10. All presenters will receive free registration to the conference. For requirements, contact Ann Thompson at athompson@aia.org or Alice Sinkevitch at 312/670-7770.

The deadline for ordering submission packages for the **Business Week/Architectural Record Awards** is March 16. For details on this prestigious award, visit www.e-architect.com or call 888/242-4240.

Interaction by Design: Bringing People and Plants Together for Health and Well-Being, the American Horticultural Therapy Association's annual conference, will be hosted by the Chicago Botanic

Garden, July 20 through 22 in Glencoe. The symposium will address issues of design and use of outdoor spaces. Proposals for project presentations, poster presentations and workshops are being requested. For complete details, call 847/835-8231 ext. 4. The deadline is April 1.

April 3 is the deadline for the **2000 Excellence in Structural Engineering Awards** sponsored by the Structural Engineers Association of Illinois. For complete details and an entry form, contact the SEA01 at 312/372-4198 or www.seaoi.org.

Home & Garden Television's **Before and After** series is looking for whole-house remodeling projects in the

Chicago area to be featured on cable TV. The time commitment is minimal and it's great exposure. (Just ask AIA Chicago members Robert Sierzega, AIA and Applied Design Associates Ltd. among others.) The criteria are (1) no demolition or construction have taken place yet, and (2) the remodel must have dramatic changes on the exterior *and* interior. For information, contact Seth at 612/835-4455 or sethk@nwtele.com

PROFESSIONAL DEVELOPMENT

Archeworks, 625 N. Kingsbury St., is sponsoring a **Star Architects Lecture Series** with Michael Graves, FAIA on Wednesday, April 26 and William McDonough, FAIA on Sunday, May 14. All lectures begin at 6:00 p.m.

SENIOR ARCHITECT

Area Manager: Full-time Chicago area. Senior Architect to develop and manage a comprehensive forensic A/E area practice. Varied professional background and long-term knowledge of area. This is an opportunity for professional and financial growth for someone who has technical, managerial, marketing and sales skills, and is willing to work hard.

More information on and respond via www.RobsonLapina.com

Sabo & Zahn
Attorneys at Law

Werner Sabo, FAIA

James Zahn, AIA

Copyright protection, business formations
mediation, litigation, arbitration, contracts, real estate
construction attorneys

8620 Sears Tower
Chicago, IL 60606
wsabo@sabozahn.com

www.sabozahn.com

(312) 655-8620
fax: (312) 655-8622
jzahn@sabozahn.com

What to do? How to do it?

Kristine Fallon Associates, Inc.

<http://www.kfa-inc.com>

Hardware
Software
Networks
Internet

30 East Adams Street, Suite 600
Chicago, IL 60603-5609
312-641-9339 (voice)
312-641-9337 (fax)
kfainc@kfa-inc.com

Get it done. Keep it going.

Chicago Women in Architecture (CWA) will hold a book club meeting on Friday, March 17 at The Corner Bakery, 1121 N. State St. The group is reading *Stiffed: The Betrayal of the American Man* by Susan Faludi. Call Susan van der Meulen, 312/787-0347. On Saturday, April 8, CWA will have its annual brunch with keynote speaker Margo Grant Walsh, vice chair of Gensler. For more information, contact the CWA at 312/409-8855.

The Graham Foundation for Advanced Studies in the Fine Arts is sponsoring three lectures this month of interest to architects. During *The Logic of Bones* on March 9, Professor Paula Young Lee examines the intricate relationship between architectural spaces and scientific practices at the Museum of Natural History in Paris. On March 22, photographer Balthazar Korab discusses the importance of models in *Eero Saarinen: Between Earth & Sky*. On March 26 in *The Favored Circle*, Garry Stevens, an architectural sociologist, tells why he believes famous architects owe their

success not so much to genius as to a host of factors having very little to do with native talent. All lectures take place at 4 W. Burton Place at 6:00 p.m. Admission is free, but seating is limited to the first 150. For more information, visit www.grahamfoundation.org.

The Illinois Department of Public Health is offering a seminar on the **Health Care Facilities Code** (NFPA 99) April 4 through 5 at the Indian Lakes Resort in Bloomingdale. All participants will receive a copy of the NFPA 99 handbook and *Health Care Facility Fire Safety* by Burton Klein. AIA members can self-report continuing education learning units that qualify as health, safety and welfare (HSW) hours. The fee is \$150 per person. Registration is required by March 4. Call 217/785-4264 for complete details.

VARIOUS MATTERS

The work of artist and architect Rebecca Alston, Assoc. AIA will be featured in **Drawings from the Urban Art**



*An Internet Site
Created
Exclusively
for Architects
and Designers*



www.parksite.com/architect

Sponsored By

Parksite Inc.
(800) 338-3355



- Professional Liability
- Specific Project Coverage
- Office Packages
- Workers Compensation
- Automobile
- Exclusive Programs
- Group and Individual Life & Health

Insurance and Loss Prevention Services for Architects

AVA Insurance Agency
One Tower Lane • Oakbrook Terrace, IL 60181
Tel: 630.571.4500 • Fax: 630.571.4518 or 4525
E-Mail: info@avains.com



Botti Studio of Architectural Arts, Inc.
919 Grove Street, Evanston, IL 60201
847/869-5933 • Fax: 847/869-5996 • 800/524-7211
www.bottistudio.com • botti@bottistudio.com

Designers/Fabricators • Stained and Faceted Glass • Beveled Glass • Sandblasted • Stained Glass Restoration and Conservation • Protective Glazing • Wood and Metal Frame Restoration • Sculpture • Bronze • Metal • Marble • Mosaic • Interior Renovation • Woodwork • Murals • Painting and Decorating • Custom Sanctuary Furnishings • Stained Glass Consultants to Architects and Churches

Field Representatives Nationwide

Studios: San Diego • Chicago • Sarasota
760/753-0705 • 847/869-5933 • 941/951-0978

Notebook

Continued from page 21

Series at The Society for the Arts, 1112 N. Milwaukee Ave. from March 31 to April 23.

The Frank Lloyd Wright Home and Studio Foundation seeks **drafting tools from 1895 to 1920** for an authentic reproduction of the interior appearance of Wright's first studio. If you are able to donate such items for a permanent exhibit, or have information on other sources for tools, please contact the curator, Cheryl Bachand, at 708/848-1976 ext. 242 or bachand@enteract.com.

NEW MEMBERS

AIA

David Birnbaum, The Environments Group; **Paul Bouchard**, Edwards & Kelcey; **Richard Click**, HOK; **Juergen Fuss**, Packer Engineering; **David Gutierrez**, McClier; **Kristin Hargrove**, DeStefano and Partners; **Kate Hauserman**, VMC Architects; **Heidrun Hoppe**, Heidrun Hoppe Associates Inc.; **Harry Hunter**, AVIS; **Dwayne MacEwen**, DMAC Architecture; **Donald Maynard**, Garapolo/Maynard; **Frank Mraz**, Lohan Associates; **Steven Nilles**, Lohan Associates; **Robert Oppenborn**, Oppenborn Reynolds Design; **Steven Santucci**, McClier; **Steven Suski**, Loeb, Schlossman & Hackl; **Keith Tyschper**, LR Development Co.; **Michael Vasilko**, VMC Architects

Associates

Darryl Crosby; **Michael Hildebrandt**, Tinaglih Design Group Inc.; **Curtis Jones**, Gould Evans Goodman; **Gordana Nikolic-Delic**; **Anne Palmore**; **Jeffrey Sandberg**, Legat Architects; **John Schweder**, Wellner Architects; **Zahyr Siddiqi**; **Michael Ward**, Wiss Janney Elstner Associates



**Midwest Visual
communications**

**Multimedia
System
Integrations**

audio • video
control systems
installations • parts
labor • service

• presentation rooms
• training centers
• conference rooms
• meeting facilities
• auditoriums
• boardrooms
• classrooms

Midwest Visual Communications
6500 N. Hamlin Ave
Chicago, IL 60645
800.876.8298
847.673.4525

www.midwestvisual.com

Emeritus

Edward Deam, University of Illinois at Chicago; **Terry Stark**, Paul H. Schwendener; **Ivan Tshilds**, Jensen & Halstead; **Wilmont Vickrey**, VOA Associates

Student

Theodore Bridges, Triton College

design solutions

design excellence

Structural, site/civil, environmental, and landscape design for the Milwaukee Art Museum addition.

structural engineering
site design & planning
transportation & traffic studies
stormwater management
sustainable design
environmental studies/planning
construction services
parking planning & design

engineers & scientists

**GRAEF
ANHALT
SCHLOEMER**
and Associates Inc.

8501 West Higgins Road, Suite 280
Chicago, Illinois 60631 773/399-0112

Chicago Milwaukee Madison Green Bay

DIGITAL CONSULTANTS · 3D MODELING · RENDERING · PRESENTATION GRAPHICS
 ANIMATION · GRAPHIC DESIGN · ENVIRONMENTAL GRAPHICS · DIGITAL PRINTING
 312.697.1107 WWW.VERTEXGRAPHICS.COM

TKTS2K COMPETITION ENTRY
 TIMES SQUARE NY, NY

VERTEX GRAPHICS
 600 S DEARBORN #2008 CHICAGO IL 60605

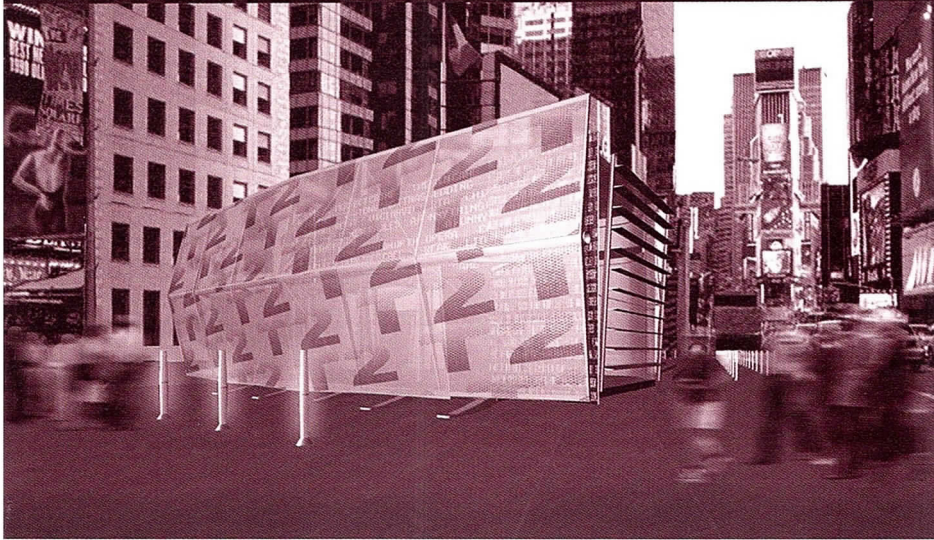

Another DRAINAGE SOLUTION by Mortar Net™



Mortar Net Block prevents water damage in single wythe concrete masonry unit (CMU) walls by breaking up mortar thereby allowing proper drainage to the weep holes. For more information, please contact Mortar Net at 800-664-6638 or visit our Web site at www.mortarnet.com.

800-664-6638
www.mortarnet.com

 **Mortar Net™**
 The Difference Is In The Cut.



Architectural

Project:
 330 West Grand Condominiums

Rendering

Client:
 Atlantis Properties, Inc.
 Howard Robinson

Imaging

Architect:
 Pappageorge Haymes Ltd.
 David A. Haymes, AIA
 Brian J. Kidd, AIA
 Joe Villanti

Animation

imagefiction

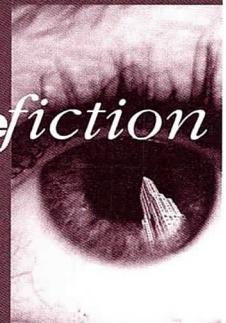

Graphic Design

LaSalle Wacker Building
 221 North LaSalle Street
 Suite 1510
 Chicago, IL 60601

312.726.0818

Color Printing

- 1 Forging Partnerships for the 21st Century.** Rita Atlas, director of regional programs, Office of the Mayor. 12:15 p.m.; Chicago Architecture Foundation, 224 S. Michigan Ave.
- 5 Exhibit: Emerging Visions.** At the Chicago Architecture Foundation, 224 S. Michigan Ave., through April 28.
- 8 Meet the Planners: Kevin Brubaker.** Planning & Urban Affairs PIA. 12:00 noon; AIA Chicago. Bring your lunch; beverages will be provided. 1LU/1HSW
- Old Buildings: New Challenges and Opportunities.** Leonard Koroski, AIA, Lohan Associates. 12:15 p.m.; Chicago Architecture Foundation, 224 S. Michigan Ave.
- 9 REITs 2000 and Beyond.** Corporate Architects PIA. 5:30 p.m.; AIA Chicago. 1.5 LU
- The Logic of Bones.** Professor Paula Young Lee. 6:00 p.m.; Graham Foundation, 4 W. Burton Place. Information: www.grahamfoundation.org.
- 11 Tour: Northfield Block Plant.** Young Architects PIA. 9:00 a.m. (sharp); The Merchandise Mart (south side). The bus returns by 12:15 p.m. 1.5 LU/1.5 HSW
- 15 Tall Projects Worldwide.** Adrian Smith, FAIA, Skidmore, Owings & Merrill LLP. 12:15 p.m.; Chicago Architecture Foundation, 224 S. Michigan Ave.
- 16 Chicago Plan Commission.** Monthly meeting. 1:00 p.m.; City Council Chambers, 121 N. LaSalle St., 2nd floor.
- 17 Chicago Women in Architecture.** Book group. 6:30 p.m.; The Corner Bakery, 1121 N. State St. Reading: *Stiffed: The Betrayal of the American Male*. Contact: Susan van der Meulen, 312/787-0347.
- 20 Burnham's Plan of Chicago: Another Look.** Kristen Schaffer, assistant professor, School of Architecture at Syracuse University. 6:00 p.m.; Chicago Architecture Foundation, 224 S. Michigan Ave. RSVP: 312/922-3432 ext 909.
- 21 An Energy Code for Chicago.** Environment PIA. 5:30 p.m.; AIA Chicago. 1.5 LU/1.5 HSW
- 22 The New Old St. Mary's.** Edward Webb, Prisco, Serena and Sturm. 12:15 p.m.; Chicago Architecture Foundation, 224 S. Michigan Ave.
- Eero Saarinen: Between Earth & Sky.** Balthazar Korab. 6:00 p.m.; Graham Foundation, 4 W. Burton Place. Information: www.grahamfoundation.org.
- 26 The Favored Circle.** Architectural sociologist Garry Stevens. 6:00 p.m.; Graham Foundation, 4 W. Burton Place. Information: www.grahamfoundation.org.
- 27 Michael Gabellini.** Gabellini Associates of New York. 7:00 p.m.; University of Illinois at Urbana-Champaign, Plym Auditorium, Temple Buell Hall, 611 Taft Drive, Champaign. Admission is free.
- 29 Egyptian Revival Architecture.** Heather Manning, School of the Art Institute. 12:15 p.m.; Chicago Architecture Foundation, 224 S. Michigan Ave.
- Interested in Design/Build?** PIA planning meeting. 5:30 p.m.; OWP&P, 111 W. Washington.
- 31 M. David Lee, FAIA.** Stull and Lee of Boston. 5:00 p.m.; University of Illinois at Urbana-Champaign, Plym Auditorium, Temple Buell Hall, 611 Taft Drive, Champaign. Admission is free.

AIA Chicago



A Chapter of The American Institute of Architects
 222 Merchandise Mart Plaza
 Suite 1049
 Chicago, Illinois 60654
 312/670-7770
 312/670-2422 (fax)
info@aiachicago.org
www.aiachicago.org

Periodical