

# Focus

## Design-Build

Architects Lead the Way  
With Their Own Programs

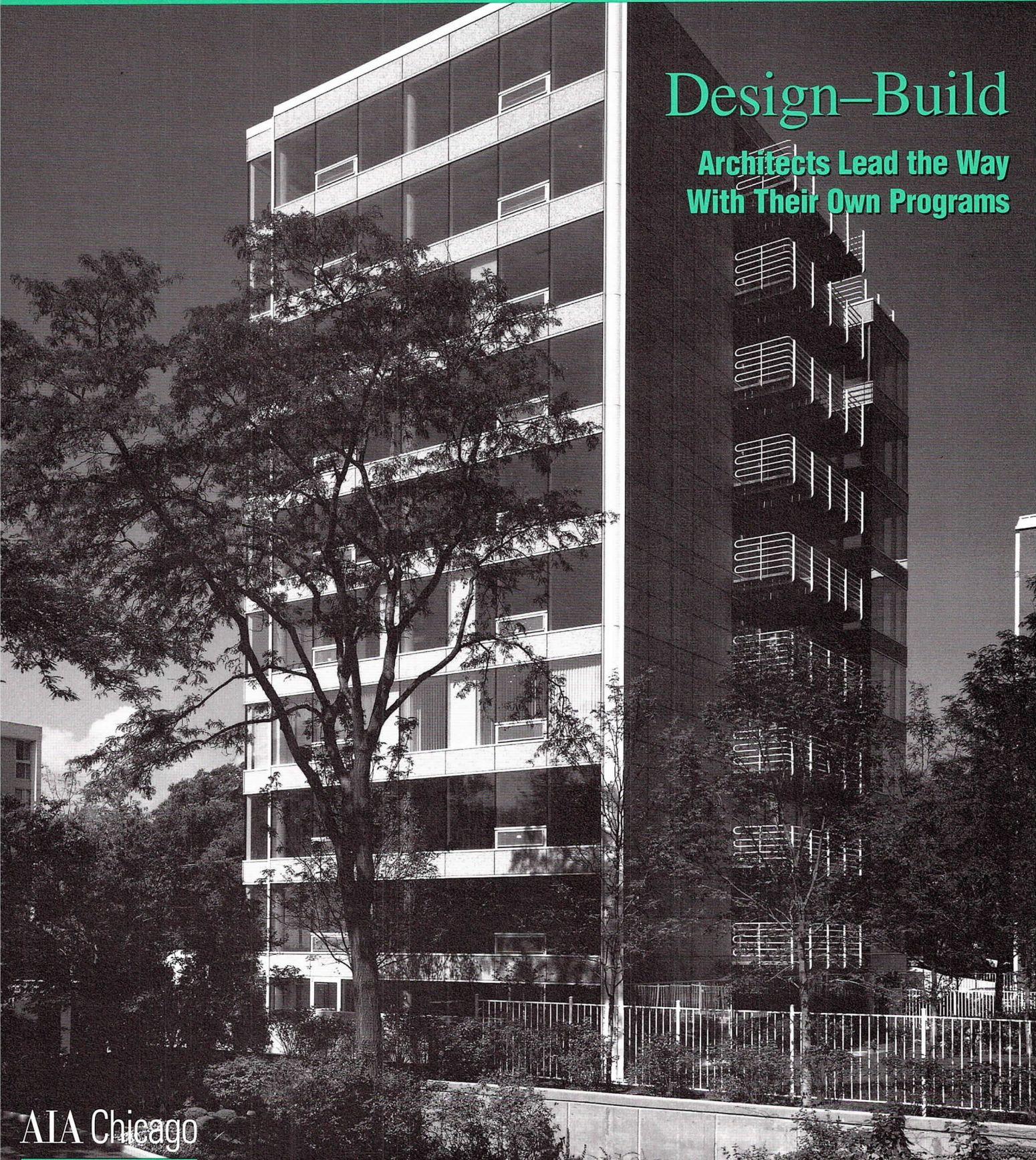



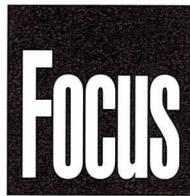

3  
Focus on Programs

4  
News Briefs

6  
Cover Story  
*Multiply Your Profits  
as a Design-Builder*

9  
Feature  
*The Ethics of  
Design-Build*

11  
Notebook

16  
Calendar

Cover Photo: Scott McDonald, Hedrich Blessing.  
Cover Project: A 10-story granite clad building at 1618  
N. Sheridan Road in Wilmette. The design-build project  
by Optima Inc. features one luxury condominium on  
each floor. With open floor plans, floor to ceiling glass,  
and outdoor balconies, the building takes full advan-  
tage of its lakeside location.

**February 1997**

**Editor**

Susan Nelson

**Focus Advisory Board**

William Bradford, AIA  
Randall Deutsch, AIA  
Peter Exley, AIA  
Joan Pomaranc  
W. Stephen Saunders, AIA  
Merritt Seymour, IDSA, CMG  
Alice Sinkevitch  
John Syvertsen, AIA

FOCUS (ISSN 1071-3700) Vol. 17, No. 2, is published monthly except May and October, with a combined issue June/July, by AIA Chicago, 222 Merchandise Mart Plaza, Suite 1049, Chicago, Illinois 60654-1001. \$20 of each member's dues are allotted as a subscription. Periodicals postage paid at Chicago, Illinois. POSTMASTER: Send address changes to Focus, AIA Chicago, 222 Merchandise Mart Plaza, Suite 1049, Chicago, Illinois 60654-1001.

For advertising rates and schedules, call 312/670-7770.

© 1997 The American Institute of Architects Chicago. All rights reserved. Reproduction in whole or part without permission is strictly prohibited.

AIA Chicago on the Internet: [www.aiachicago.org](http://www.aiachicago.org)  
AIA Chicago e-mail: [aiachgo@mcs.com](mailto:aiachgo@mcs.com).

# AIA Chicago



A Chapter of The American  
Institute of Architects

**1997 Board of Directors**

**President**

W. Stephen Saunders, AIA

**President-Elect**

Deborah Doyle, AIA

**Vice Presidents**

Thomas Fridstein, FAIA  
Thomas Zurowski, AIA

**Secretary**

T. Gunny Harboe, AIA

**Treasurer**

James Jankowski, AIA

**Directors**

Hill Burgess, AIA  
Randall Deutsch, AIA  
Jonathan Fischel, AIA  
Doug Garofalo, AIA  
Harold Olin, FAIA

**AIA Regional Director**

Gaines Hall, FAIA

**AIA Illinois Director**

Holly Gerberding, AIA

**Associate Director**

Lee Waldrep, Ph.D.

**Professional Affiliate Director**

Merritt Seymour, IDSA, CMG

**Past President**

John Syvertsen, AIA

**1997 AIA Illinois Delegates**

Thomas Braham, AIA  
Kenneth Crocco, AIA  
Dirk Danker, AIA  
Richard FencI, AIA  
Janet Hahn Lougee, AIA  
William Worn, AIA  
Kevin Hall, AIA (alternate)  
Arthur Salzman, AIA (alternate)

**Chapter Staff**

**Executive Director**

Alice Sinkevitch

**Membership Coordinator/Assistant to the Director**

Mark Crossley

**Program Director**

Joan Pomaranc

**Focus Editor**

Susan Nelson

**Financial Manager**

Crystal Gagler

**Public Information Receptionist**

Margie McArdle Smith

**Marshall Strabala of SOM**

Wednesday, February 5, 6:00 p.m.  
 Skidmore Owings & Merrill LLP,  
 224 S. Michigan Ave.  
 Sponsor: Young Architects PIA



A roundtable discussion with Marshall Strabala, an associate at Skidmore Owings & Merrill LLP. Part of a continuing series of discussions with local architects about their philosophy and work. 2 LUs.

**Facility Planning for Obstetrical Services**

Wednesday, February 12, 5:30 p.m.  
 AIA Chicago  
 Sponsor: Architecture for Health PIA



Joyce Huber Durham, RN, AIA discusses major trends in obstetrical facilities planning and presents the new hybrid LDR/LDRP concept known as LDRPlus. As a principal at Chi System's facility planning group, Durham plays a major role in facility planning and programming and is highly skilled at addressing facility issues related to clinical departments. She has presented at various national conferences on future trends in facility planning and redesign for ambulatory care and nursing services. 3 LUs.

**Brown Fields**

Tuesday, February 18, 6:00 p.m.  
 AIA Chicago  
 Sponsor: Environment PIA



Michael Iversen, AIA moderates a panel on recent changes in state and federal environmental regulations designed to promote the redevelopment of contaminated urban industrial sites, or brownfields. The panel will discuss design and development issues, including regulations, health and safety, and project funding. The city of Chicago has successfully demonstrated that both the environmental and financial goals can be met with brownfield reclamation pilot projects. Panelists include William Trumbull, assistant commissioner

of the city's Department of Environment, Robert Walter of Boelter Environmental Consultants, Ignazio Correo-Ariz, of the Center for Neighborhood Technology, and a private developer. Co-sponsored by the Real Estate PIA. 3 LUs.

**Instant, Instinctive Marketing Part I**

Wednesday, February 19, 5:30 p.m.  
 AIA Chicago  
 Sponsor: Office Practice PIA



Barry Koren, AIA, Ph.D. presents basic tips for improving your firm's marketing. Discover some small but key marketing actions that can turn into habits. Identify techniques that can win opportunities and clients. 3 LUs.

**1996 Design Excellence Awards Submissions**

Tuesday, February 25, 5:30 p.m.  
 AIA Chicago  
 Sponsor: Design PIA

This slide review of submissions to last year's Design Excellence Awards is a great opportunity to see and discuss the recent work of many Chicago firms.

**Architecture: Professional Pathways**

On Saturday, March 8, AIA Chicago's Education to Practice Task Force is holding the second annual Professional Pathways conference at the Circle Center on the campus of the University of Illinois at Chicago (UIC). The half-day program allows architecture students and interns to learn more about the various careers available to them within the profession of architecture. Following presentations by a panel of local architects, participants meet with panel members in small group discussions. Architects wishing to participate as speakers are encouraged to call Doug Garofalo, AIA at UIC, 312/996-3335. For information about the event itself, call Lee Waldrep, Ph.D. at IIT, 312/567-8835.



**Sign Me Up!**

- 2/5 Young Architects PIA:  
Marshall Strabala of SOM
- 2/12 Architecture for Health PIA:  
Facility Planning for Obstetrics
- 2/18 Environment PIA: Brown Fields
- 2/19 Office Practice PIA:  
Instant, Instinctive Marketing
- 2/25 Design PIA:  
1996 Design Awards Submissions

Name \_\_\_\_\_

Office \_\_\_\_\_

Address \_\_\_\_\_

City \_\_\_\_\_

Phone \_\_\_\_\_

Fax \_\_\_\_\_

All programs listed above are free or as noted for AIA Chicago members. Non-members will be charged \$10 per program or as noted.

**Method of Payment**

- Check
- American Express     Visa     Mastercard

Credit Card No. \_\_\_\_\_

Expiration Date \_\_\_\_\_

Name on Card \_\_\_\_\_

Signature \_\_\_\_\_

Mail or fax to:  
**AIA Chicago**  
 222 Merchandise Mart Plaza, Suite 1049  
 Chicago, Illinois 60654  
 Fax 312/670-2422





Doug Farr & Associates

### *Board Approves Funding for Structural Work Act Study*

The AIA Chicago board of directors has agreed to help fund a study that will update a 1986 report on the economic impact of Structural Work Ordinances. The board did so in an effort to head off a Structural Work Ordinance for Chicago introduced almost a year ago by Alderman Patrick O'Connor of the 40th Ward (*Focus*, June 1996). The state's Structural Work Act was repealed in 1995.

The professional liability insurance community also provided support of the study through contributions from DPIC Companies, Professional Indemnity Management Co. and RA&MCO Insurance Services.

Compiled by Watson Wyatt Worldwide, the report will evaluate the impact of a Structural Work Ordinance on the cost of construction and on the competitiveness of Chicago businesses compared with those located in suburban communities. The

study will also examine the Ordinance's affect on construction site safety.

According to the Chicagoland Chamber of Commerce, which is spearheading a broad coalition of construction and business groups, Alderman Bernard Stone (50th Ward), chair of the Building Committee, wants the Structural Work Ordinance proposal on the city council's agenda early this year.

### *AIA Chicago to Hold Fourth Annual Lecture Series*

AIA Chicago's fourth annual public lecture series examines Transformations—recent projects that exemplify the architect's role in the redevelopment of communities and the rethinking of spaces. The series includes eight lectures and begins on Wednesday, March 19. These free programs are held at the Chicago Cultural Center, 78 E. Randolph St., and begin at 5:30 p.m.

### *Landmarks Division Releases Storefront Conversion Guide*

The Landmarks Division of the Department of Planning and Development has released *Converting Storefronts to Housing*, a detailed guide for architects, developers and building owners. The book contains numerous photos, renderings and floor plans from Chicago-area projects as well as several detailed case studies.

"Thousands of storefronts stand vacant or underused along Chicago's 500 miles of commercial arterials, remnants of once-thriving neighborhood shopping districts of the late 19th and early 20th centuries," according to the book. "Rehabbed into dwelling units, these former storefronts could bolster a city's residential neighborhoods, and become a sought-after housing alternative."

**EUCLID**

**AIA Chicago 401(k) and Profit Sharing Association Plan**

IRS compliance is a key factor in the cost of pension plan administration costs. By combining smaller firms together in a larger group, the costs will be lower. That is exactly what the AIA Chicago 401(k) and Profit Sharing Association Plan did. Euclid and Hinz Consulting Services developed a plan that will allow smaller employers to offer the same options as their larger counterparts. These charges include everything for a "turn-key" pension plan... filings, 5500's testing, investing, reporting, bookkeeping...

For more information, please contact :  
**Jim Lorenz at 630 833-1000**

**Euclid Pension Services, Inc.**  
 977 Oaklawn Avenue, Elmhurst, IL 60126

**We have Big Plans for your Small Firm**





A storefront conversion project by Doug Farr & Associates. The project, shown here in before (left) and after (right) shots, is a featured case study in the city's new guide to converting these commercial spaces to residences.

Doug Farr & Associates

To order a copy of the publication, send \$7 to the Department of Planning and Development, City Hall, Room 1000, 121 N. LaSalle St., Chicago, IL 60602.

### Chicago Women in Architecture Sponsor Career Development Fair

Chicago Women in Architecture (CWA) will host its annual Portfolio, Resume and Mock Interview Seminar in April and is looking for professional architects to volunteer to review portfolios and conduct mock interviews. The free workshop is designed for students and job-seekers. For information, call Darci Oberly at 312/341-9898.

### What You'd Never Guess About CES

NCARB can help you earn CES Learning Units at your convenience. Through its Professional Development Program, NCARB offers a series of monographs that include a self-administered quiz. Read and study the monograph, take the quiz, and a passing score will earn you 30 learning units that meet the health, safety and welfare requirement and which NCARB reports directly to AIA.

The newest title in this series, *Fire Safety in Buildings*, was recently released. Its two authors are both architectural educators and volunteer firefighters who present life-safety needs in buildings from the perspective of the fire-fighting industry.

Other titles in the series include *Energy*

*Conscious Architecture, Indoor Environment, and Subsurface Conditions. Design for Wind Forces* will be published in June. Currently in development are monographs on building codes and low slope roofing.

Each monograph costs \$55 which includes the book, quiz, scoring, reporting, and record-keeping. An order form can be printed off the NCARB home page on the World Wide Web at [www.ncarb.org/services/order.html](http://www.ncarb.org/services/order.html), or requested by phone 202/783-6500, fax 202/783-0290, or mail: 1735 New York Avenue, NW, Suite 700, Washington, D.C. 20006.

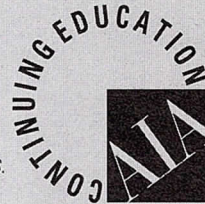

Let us help you visualize your ideas

# imagefusion

from Sketches, Plans or .dxf

Architectural Renderings,  
Presentation Media from  
2-D, 3-D to CD-ROM

300 West Adams Street  
Suite 700  
Chicago, Illinois 60606  
Contact: Eric Brightfield

312.726.0818  
Fax 726.1118

Architect: Nagle Hartray  
Danker Kagan McKay

Owner: Francis Parker School

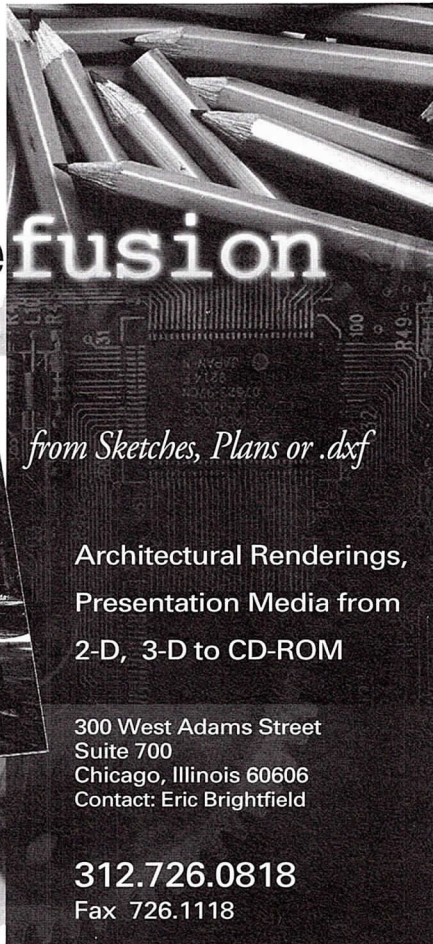



# Multiply Your Profits as a Design-Builder

## Architects Lead the Way With Their Own Programs

by Mark Friedlander

**D**esign-build is by far the fastest growing method of project delivery in the country. Its popularity is owner-driven, primarily because of shortened project delivery times and the single point responsibility for project design and construction.

Architects have been somewhat irresolute about design-build. They have feared it diminishes the design professional's role and the importance of design to the project. There is some validity to these criticisms because architects have traditionally played a subservient role to the contractor in design-build projects.

Historically, the reverse was true. The architect as master builder had overall responsibility for the project, both the design and construction. However, as the legal climate became more adversarial, architects responded by reducing their responsibilities for construction, carving



"The main advantage to design/build is that the architect has more control over the project," said David Hovey, FAIA, president of Optima Inc., the design-builder of this glass and steel residence on the North Shore. "I believe that this approach is very conducive to high quality design and construction." A 20-year-old real estate development/architecture firm, Optima Inc. averages \$35 million a year in construction.

Jon Miller, Hedrich Blessing



"The architect's role has been diminishing over the years. We've become isolated," said George Pappageorge, FAIA. "When you take on a project as a design/builder, you go in the opposite direction. You open yourself to other disciplines such as finance and real estate. You come to understand the buyer's mentality and what makes [a project] work for them." Pappageorge/Haymes Ltd. was responsible for this loft project on West Altgeld Street in Chicago.



Pappageorge/Haymes Ltd.

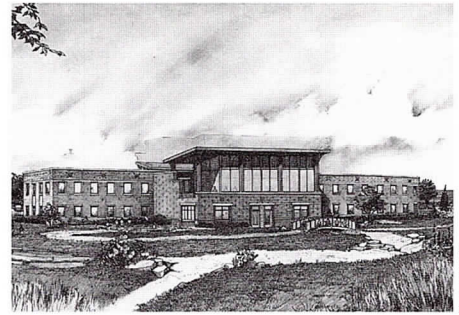

Bruce Bonidy

DLK Architecture recently founded DLK/Build to offer comprehensive design and construction services to its clients. One of DLK/Build's first projects is this 28,000-square-foot program and service center for the Girl Scouts/Illinois Crossroads Council. "I've spent my entire career as an architect hearing that design-build was a bad idea," said project manager Hill Burgess, AIA. "Now that I've done it, I think it's fabulous."

out the ever-narrowing niche they now occupy.

## The Architect as Prime

I advocate that architects redefine their role, particularly in design-build projects. Architects have traditionally been subcontractors or joint venture partners of the contractor, presumably because of the contractor's stronger financial status. But it is usually the architect who develops the initial relationship with the owner and who has the owner's trust and confidence when construction begins. I submit that it is more logical (and far more profitable) for the architect to be the prime design-builder, subcontracting the actual construction to the contractor.

The first step I recommend is for the architect to form a strategic alliance with a financially sound or bonded general contractor. The contractor will agree to provide extensive pre-construction services (estimating, value engineering, constructability review, etc.) in exchange for the architect's promise to subcontract 100 percent of the construction work to the contractor.

The second step for most architects is to establish a sister company to be the architect's construction division. This company enters into a Master Subcontract Agreement with the contractor which

calls for the contractor to perform all of the construction for a cost (or with a guaranteed maximum price) of 95 percent (for example) of what the owner pays to the architect's construction company for the construction.

I suggest setting up the design-build agreement with the owner differently from what is contemplated in most standard form contracts. The architect may begin the project with a B-141 contract. If the owner elects to have the architect construct the project, then they sign a document establishing the construction price and completion date. This document may be signed at any time during the design phase, whenever the owner's program is sufficiently understood to establish the price and duration of the project. This can even occur early in the schematic phase, in which case the architect designs to the construction price as if it were a budget.

The contractor is closely involved in establishing the construction price and subsequent design because the contractor is promising to the architect that the project can be constructed for 95 percent (for example) of the construction price given to the owner. When the construction documents are sufficiently developed so that construction can begin, the owner then signs a lump sum construction contract with the architect's construction company which incorporates the price and schedule terms previously agreed.

## Advantages When the Architect is Prime

Structuring a design-build project in this manner affords four significant advantages to the architect. First, it enables the architect to participate in construction profits which dwarf the profits from the design phase. Informal research among architectural firms that take the lead in design-build projects indicates that the ratio of construction to design profits exceeds four to one. There is a potential for even greater profits from construction savings when the owner-architect construction contract is for a lump sum and the architect-contractor subcontract is cost-plus with a guaranteed maximum price.

The second major advantage is in marketing. The architect will be able to offer an owner a design-build option that the owner may elect or not, at the owner's discretion, any time during the design phase. Architects employing this approach have found that the ability to perform both the design and construction of the project separates them from their competitors and results in many more commissions, even for projects that are ultimately delivered in a more traditional manner.

The third advantage is control of design. An architect who is prime can

*Continued on page 8*



## Design-Build

Continued from page 7

control the quality of design and ensure that the construction implements the design.

The fourth advantage is minimized problems during the construction phase. The contractor would not be entitled to change orders for errors or omissions in the construction documents because the contractor participated in creating them. The architect-contractor relationship is non-adversarial, with the contractor assisting the architect in correcting unanticipated design problems, and the architect assisting the contractor by flexible interpretation of the design, allowance of substitutions, etc. Construction worker injury claims would no longer be defended under the professional liability policy, with its large deductibles, because the architect's

liability is as a contractor, covered under the contractor's general liability policy.

### Minimal Risks and Obstacles

The major risk in architect-prime design-build is liability to the owner for construction defects and related problems. But if the architect is liable to the owner, the contractor is similarly liable to the architect. This is the theory of general contracting. As long as the contractor is financially sound or bonded, the architect's ultimate financial risk is minimal.

This design-build structure will not always be optimal or workable. It would have to be modified for public projects in some jurisdictions because of competitive

bidding laws. The licensure laws some states also may create an obstacle. And, this project delivery method is not designed for an owner whose primary goal is to obtain the lowest possible price.

Additionally, this design-build structure is ideally suited to most private sector projects, particularly those that are driven by schedule or budget. Owners and contractors alike have expressed great interest in this project delivery style. ■

*Mark Friedlander is a partner in the Construction Law Group of Schiff Hardin & Waite in Chicago. He is an adjunct professor at the University of Illinois School of Architecture and has been a lecturer at the University of Wisconsin at Madison and the Illinois Institute of Technology. He is currently chair of the Professional Practice and Contracts Committee of the Design-Build Institute of America.*

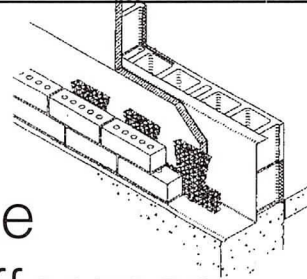
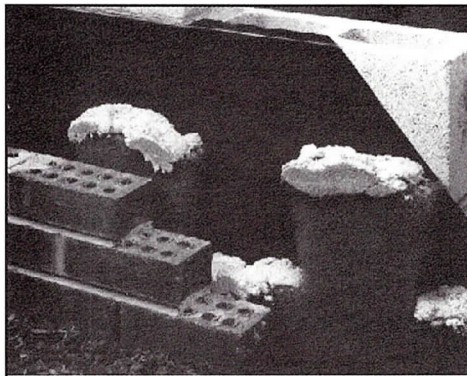

The  
Difference  
is in the Cut.

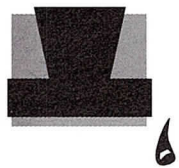

**Mortar Net**<sup>TM</sup>  
USA, LTD

TO ORDER MORTAR NET<sup>TM</sup> CALL  
SEALANT ENGINEERING ASSOCIATES AT

**6 3 0 8 6 0 7 8 7 8**

FOR TECHNICAL DATA AND A FREE  
SAMPLE KIT OR TO ORDER  
MORTAR NET<sup>TM</sup> CALL

**8 0 0 6 6 4 6 6 3 8**

Weep Holes Stay Open— Mortar Net<sup>TM</sup>  
collects mortar droppings inside masonry  
cavity walls

Fast, Easy Installation— requires no  
fasteners or adhesives, no special skills or  
tools

5' long sections in 4 nominal sizes:  
10" high x2", x1", x0.8" or x0.4" thick and  
16" high x 1" thick

### Are you one system crash away from crisis?

#### KRISTINE FALLON ASSOCIATES, INC.

You know us as the experts in CAD  
systems planning and automating  
A/E work processes. Now we're  
there for the follow through with:

#### On-Site Technical Support Services

Think of us as your computer  
support staff who doesn't need  
office space. Call on us to:

- Develop procedures  
for optimal systems operation
- Inventory and maintain  
your hardware and software
- Troubleshoot systems problems

For planning and support, call:

#### KRISTINE FALLON ASSOCIATES, INC.

30 E. Adams Street, Suite 600  
Chicago, IL 60603  
312.641.9339  
72073.557@compuserve.com



# The Ethics of Design-Build

## How can we guard the henhouse when we are working for the fox?

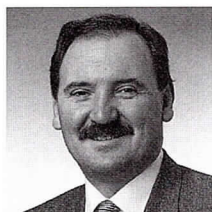

Clifford Bedar, AIA (left) and Michael Behm, AIA

by Clifford Bedar, AIA and Michael Behm, AIA

As we travel across the country and talk about our experiences as design-builders, we hear many reasons why architects are leery of design-build. One of the more consistent concerns is the question of ethics. How can the architect act in the client's best interest when they serve as both the designer and the builder?

The question is an ironic one. The ethics dilemma is a self-fulfilling prophecy that architects helped create and continue to nurture. The traditional design-bid-build process creates adversarial relationships which force more fundamental ethics issues. By its very nature, this does not act in the client's best interest, and consequently, the public's best interest.

It may be true that our ethics are challenged when we subcontract to a general contractor as part of a design-build team. We may be forced to make bad design decisions to increase project profitability, or look the other way during construction. How can we guard the henhouse when we are working for the fox?

The public sector, the litmus test for all ethics questions, has addressed this issue by adopting the two-step design-build method. In this low-bid process, an initial architect, recently dubbed "the design criteria professional," is responsible for communicating the infamous design intent in the form of an RFP for a design-builder to interpret and execute.

Is it any more ethical when the architect is in the lead in this low-bid design-build process? To answer that question, each of us must look at our own motivations when we are faced with the temptation to profit from lesser quality.

Our experience in the many forms of design-build suggests that there is one variation that addresses this particular

ethics question. It simply involves services similar to those of a construction manager for the construction portion of design-build. Both design and management of construction are undertaken as professional services, and design and construction fees are fixed. When the project cost and/or schedule is to be guaranteed, we negotiate additional fixed fees to compensate for the risk. All trade subcontracts are publicly advertised and bid which satisfies the public bidding laws for public work in most states.

Our clients reap all the benefits and efficiencies of design-build. As with any design-build process, they are able to occupy their buildings more quickly with a fast-track schedule, project costs are guaranteed early in the process, and there is a single point of responsibility.

As architects, there are many advantages. We are able to procure commissions based on our overall qualifications. We have expanded our services, more than doubled our fees, and quadrupled our profits. Just as important, we are able to achieve better quality and construction. We cannot profit from lessening the quality; therefore, our only concern is to design and build the highest quality project for our clients with their budget and schedule. We thought this is what architects were supposed to do anyway. ■

Clifford Bedar, AIA and Michael Behm, AIA are principals at Clark Dietz Inc., an architecture, engineering and design-build firm in Chicago.

### Illinois Laws Affecting Design-Build

For details, call AIA Illinois at 217/522-2309. Or refer to AIA Illinois News (1996, Issue 2, Page 5).

### Interested in a local Design-Build PIA?

Fax your name to AIA Chicago. With sufficient interest, an initial meeting will be arranged.

### Manage the Risk of Design-Build

Next month in *Focus*, an insurance expert outlines the coverage you should consider when considering design-build.



**New**

# High-Speed Digital Blueprinting

High speed digital printing from scanned originals or prints and CADD plot files. Copies may be reversed (negative to positive) mirror imaged and stretched along with standard enlargements and reductions from 25% to 400%. We would prefer HP/GL2 files with pen weights set.

For more than 70 years, Mossner has provided the latest and fastest high-production equipment available. And now Chicago's first state-of-the-art Oce 9800 for Digital Blueprinting is here!

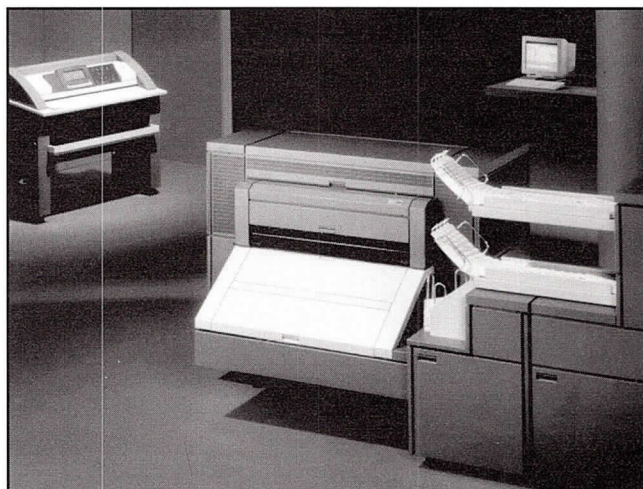

- **Pick-up and Delivery**
- **Fast Service**
- **Print Scanned Originals**
- **Print HP-GL, HP-GL/2, HPRTL, TIFF<sub>5.0</sub>, CALS<sub>1</sub> Files**
- **Print Collated Sets Fast**

## BOND PAPER DPB

Total Sq. Ft. per order	Price per Sq. Ft.
1 to 49	.50
50 to 74	.35
75 to 99	.25
100 to 199	.20
200 to 499	.19
500 to 999	.18
1000 to 1999	.17
over 2000	.15

Minimum Charge \$25.00  
\$2.00 per scan, \$1.00 per CADD File

## VELLUM PAPER DPV

Total Sq. Ft. per order	Price per Sq. Ft.
1 to 49	2.75
50 to 74	2.50
75 to 99	2.25
100 to 199	2.00
200 to 499	1.75
500 to 999	1.50
1000 to 1999	1.40
over 2000	1.35

Minimum Charge \$25.00  
\$2.00 per scan, \$1.00 per CADD File

**Mossner** (312) 372-8600  
THE REPRODUCTION PEOPLE • LARGEST IN THE MIDWEST  
Mossner Building • 137 North Wabash at Randolph (across from Marshall Field's), Chicago, IL 60602





Heinrich Blessing

NEW MEMBERS

**AIA**  
**isa Adkins**, Fitzgerald Earles Architects; **Wayne Lassa**,  
**Robert Munguia**, EDI Interior Architecture; **Todd Pape**,  
 Hancock & Hancock; **Charles Pipal**, Vinci/Hamp; **Daniel**  
**Leholz**, Legat Architects; **Gerhard Zinserling**

**Reinstating AIA**  
**Lawrence Dunlap**; **Bertrand Goldberg**, Bertrand  
 Goldberg Associates Inc.; **Michele Keller**; **David Lepper**,  
 Leibel Schlossman & Hackl/Hague Richards; **Todd**  
**Blain**, Bauhs Dring Main Architects & Planners;  
**Raynaldo Manalang**, R. Manalang Architect; **William**  
**Belletier**, First National Bank of Chicago; **Charles**  
**Wiegler, Jr.**, Lieber Architects

**Upgrades to AIA**  
**Paul Nachenberg**, EDI Interior Architecture

**Emeritus AIA**  
**Joseph Pappalardo**

**Associate AIA**  
**Heleanor Esser**, Commission on Chicago Landmarks;  
**Baron Greven**, Murphy/Jahn Inc.; **Jarrod Wallace**, Hines  
 Interest Limited Partnership; **Wilson Chow**, OWP & P

**Transfers to AIA Chicago**  
**Phillip Russo** from AIA Philadelphia

**Professional Affiliates**  
**David Gill**, Juno Lighting; **Jeffrey Hodgetts**, Hanscomb  
 Inc.; **Phillip Johnson**, Brady Brick & Supply Company

PEOPLE

**Bailey Edward Design** has relocated its offices to  
 900 N. Franklin St., Suite 402.

The **Illinois Institute of Technology** has elected  
**Thomas Beeby, FAIA**, principal of Hammond Beeby  
 and Babka, to its board of trustees. Others recently  
 elected include: James Cowie, general partner at  
 Frontenac Co.; Deborah Hockman, a vice president at  
 WMX Technologies Inc.; Stephen McConahey, president  
 of EVEREN Securities Inc.; Carl Thoma, founding prin-  
 cipal of Golder, Thoma, Cressey, Rauner Inc.; and David  
 Vitale, vice chairman of First Chicago NBD Corp.

**DeStefano and Partners** has received an honorable  
 mention from the Metal Construction Association for its  
 Division Street Gateways project.

**Phillips Swager Associates** has opened a new  
 regional office in Washington, D.C. The office will be  
 headed by **Daniel Moore, AIA** and **James Beight**,  
**AIA**, former principals with Hansen Lind Meyer.

**Federick Phillips, FAIA** has received a grant from  
 the College of Fellows of the American Institute of  
 Architects to support the creation of "Wheel People," a  
 traveling exhibition about manufactured houses and  
 their occupants.

**Skidmore Owings & Merrill LLP** has named William  
 Baker and **Philip Enquist, AIA** as new partners and  
 has promoted **Toni Griffin, AIA**; **Anwar Hakim, AIA**  
 and Phillip Sawyer to the position of associate partner.

NEW PROJECTS

**Holabird & Root LLP** has been selected to complete  
 the programming phase of the Illinois Institute of  
 Technology's new campus center. The programming  
 work includes identification of space requirements as  
 well as recommendations for their use. The completed  
 program will set the stage for an international competi-  
 tion for the design of the new center. The projected  
 75,000- to 90,000-square-foot facility will become the  
 hub of campus activity and serve as a starting point for  
 the overall refurbishment of the IIT campus.

**Interior Space International (ISI)** recently was  
 assigned three new projects totaling over 4 million  
 square feet of office space. The projects include: port-  
 folio management of Midwest and East Coast facilities  
 for Aetna Insurance, the renovation of three 16,000-  
 square-foot floors in the Chicago office of the Bank of  
 Montreal, and ongoing facilities development in  
 northern Illinois for Commonwealth Edison.

CALLS FOR ENTRY

The **Academy of Architecture, Arts & Sciences**  
 in Beverly Hills, CA is sponsoring "Bigfoot," a competi-  
 tion to design a new football stadium for Los Angeles.  
 The registration fee is \$75. Submissions are due by  
 May 31. Prizes total \$25,000. For more information, fax  
 a request to 610/299-0957.

Continued on page 12

**ARCHITEMPS, INC.®**

**ARCHITEMPS, INC.®-- the Architectural & Interior Design staffing specialists, serving greater metropolitan Chicago since 1986.**

**Quality staffing, service and solutions:**

- Design/Production Drafters
- Facility Planners
- CAD Architects/Interior Designers
- Project Managers

**Our billing includes all employer liability:**

- Payroll Administration
- Employee Benefits
- Government Compliance
- State & Federal Tax Remittance
- Workers' Compensation Coverage

**Architectural, interior design and facility planning personnel on a per-project basis. Customized employee leasing, permanent conversion and direct placement available. Call today for information on our staffing services or employment opportunities.**

**ARCHITEMPS, INC.®**  
 1050 North State Street  
 Chicago, Illinois 60610.1043

**Tel: 312.649.0912**  
**Fax: 312.649.1667**  
**ARCHITEMPS@aol.com**  
**http://www.architemps.com**



## Notebook

Continued from page 11

AIA St. Louis, sponsor of the official AIA photo contest, is now accepting entries for the **1997 AIA Photography Competition**. The competition is open to any architect registered in the U.S. Associate members of the AIA and student members of AIAS may also enter. Four cash prizes totaling \$1,800 will be awarded. In addition, images for the *1999 AIA Engagement Calendar* will be selected from all submitted entries. The deadline to submit slides—with an architectural theme—is March 1. The entry fee is \$20 for AIA members and \$25 for non-members (for five slides). Each submission must be accompanied by an official entry form. The form can be obtained by sending a self-addressed, stamped envelope to AIA St. Louis, 911 Washington Ave., #225, St. Louis, MO 63101, or from the January and February issues of *AIArchitect*.

The **Village of Plainfield** is sponsoring a single-stage, national competition for its new 300-acre Town Center. The Center is located along the bank of the Du

The Terra Museum of American Art presents "An American Century of Photography—From Dry-Plate to Digital" through March 30. The exhibits includes this 1928 photograph by Ralph Steiner.

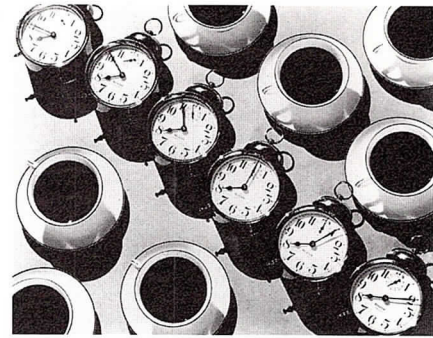

Page River, opposite the historic downtown of Plainfield. The Village needs a vision for the town center and a feasible development plan for achieving that vision. The focus of the competition will be directed toward architecture and urban design. The competitors solutions should also address landscape architecture and planning. Team entries are encouraged. Presentations will be limited to two boards, both 30" by 40" high. Monetary prizes will be awarded to winners. For a complete competition program and to register, send a non-refundable fee of \$90 to The Plainfield Competition, Village of Plainfield, 23145 W. Lincoln Hwy., Plainfield, IL 60544.

### PROFESSIONAL DEVELOPMENT

Stein, Ray & Conway will hold its **6th Annual Symposium for Design Professionals** at 8:00 a.m. on Monday, February 10 at the Chicago Marriott Downtown, 540 N. Michigan Ave. The symposium is designed to help architects meet the challenges of today's legal environment. The seminar fee is \$70; all

proceeds in excess of the program cost will be donated to the Chicago Architecture Foundation. Contact Bonnie Jean Hale at 312/641-3700 to register. Participants will receive AIA/CES learning units.

The Association of Project Managers (APM) and the National Society of Professional Engineers (NSPE) are offering **Developing Project Managers for the 21st Century**, a series of three one-day workshops prepared specifically for design and construction industry managers, in Chicago on March 19, 20 and 21. Registration fees are \$270 for one workshop for APM and NSPE members; \$295 for non-members. Additional workshops are \$225 each. Call APM at 773/472-1777.

### VARIOUS MATTERS

The Architecture and Design Society of the Art Institute of Chicago is sponsoring "**Views of Chicago**:"

## PROJECT CONTROL INC.

*A Professional Service Organization  
Established in 1974*

### PROJECT/CONSTRUCTION MANAGEMENT

Project Delivery Management  
Construction Management  
Cost Estimating  
CPM Scheduling  
On-Site Management

### PROFESSIONAL CONSULTING

Feasibility Studies  
Loan Management  
Property Inspections  
Litigation Support  
Maintenance Reports

### PROJECT CONTROL INC.

411 South Wells Street, Suite 902  
Chicago, Illinois 60607

Tel: 312/922-5151  
Fax: 312/922-6858

Division 7

## Architectural Representative

630.668.1551

Telephone



630.668.1672

Facsimile

COATING SALES LTD.

Representing Manufacturers of Quality Construction Materials Since 1977

### Koppers Industries

*Coal Tar Built Up Roofing Systems*

- Fume Recovery System—FRS 6000
- Proven Materials
- Quality Manufacturer
- Warranty

### Ludowici Roof Tile

*Clay Roof Tile Systems*

- Historic Preservation
- Proven Materials
- Quality Manufacturer
- Fine Home Construction

*Long-term, Effective Solutions to  
Your Roofing Needs*



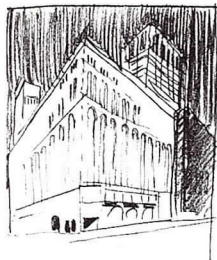

The Architecture and Design Society exhibits travel sketches by architects through May 4, including this one of the Auditorium Theater.

Alan Colquhoun

**Travel Sketches by Contemporary Architects**  
from February 14 through May 4 in Architecture Gallery 24 at the Art Institute. Call 312/996-3335.

The Terra Museum of American Art, 664 N. Michigan Ave. is exhibiting **"An American Century of Photography"** through March 30. The show features the work of Ansel Adams, Richard Avedon, Robert Mapplethorpe, Man Ray, Aaron Siskind and Alfred Stieglitz among many others. Call 312/664-3939.

AIA Chicago is seeking area architects to volunteer as **casual hosts to visiting foreign architects**. Responsibilities may include a telephone conversation, possible office visits and informal tours. Bi-lingual AIA Chicago members are encouraged to call Joan Pomaranc at 312/670-7770 to volunteer.

**AIA Chicago on the Internet:**  
[www.aiachicago.org](http://www.aiachicago.org).

**CIVIL ENGINEERING**  
Planning • Zoning • Engineering

Call Ed Resner  
630-289-4029

**CDI COMMUNITY DEVELOPMENT INCORPORATED**

**Signs Today**  
295-A N. Northwest Hwy., Palatine, Illinois 60067  
Phone: (847) 934-9777, Fax (847) 934-9965  
**LARGE & SMALL OUTDOOR SIGNS**  
(Lighted, if you like)  
**CHANNEL LETTERS**  
**BANNERS**  
Exterior and Interior  
**MONUMENTS**  
**ASSORTED MATERIALS**  
Complete Line of Indoor, Real Estate, and Neon Signs !!!  
Estimates & Repairs  
Delivery Available

**Mortgage Financing**  
Residential & Commercial

New Construction  
Rehab & Additions  
Purchase & Refinance

for loan information, call:  
**Menno Scholten, AIA**

*Illinois Mortgage Company*  
908 Waukegan Road  
Glenview, Illinois 60025  
An Illinois Mortgage Licensee

(847) 724-0000 fax (847) 724-5606

**crostree**  
INC.  
ARCHITECTURAL METALWORK  
CUSTOM ARCHITECTURE  
INTERIOR FURNITURE  
IN METAL  
**FREE Portfolio**  
Call 312.733.1234  
to receive our portfolio and see for yourself what we could do for your custom metal fabrication needs.  
500 West Cermak Rd. Box 25 Suite 815 Chicago, Illinois 60616  
Tel: 312.733.1234 Fax: 312.733.1207 E-mail: [crostree@wva.com](mailto:crostree@wva.com)

**ENVIRON, INC.**

Progressive, mid-size River North firm seeking motivated **Sr. Project Architects/Managers** with multi-family housing, senior housing, educational & institutional facility design background. Diverse clientele, creative yet casual environment, career opportunities. 5-years min. exp. with all phases from PD to CA. Ability to work directly with clients and manage a project from concept through completion. AutoCAD 12/13 a must. Salary negotiable, excellent benefits. Fax resume & salary history/requirements to Bob R. at 312/951-1719.

**Architecture Design Planning**

**The Law Offices of Cooke & Whitcomb**

**TIMOTHY P. MORGAN, ESQ, AIA OF COUNSEL**  
Twenty years experience as a practicing architect.

A Business Transactional Practice. Contracts. Strategies. Financing.  
Commercial & Residential Real Estate. Construction. Arbitration. Litigation.

111 E. Wacker Dr.  
Suite 3021  
Chicago, Illinois 60601

TLPH (312) 240-9002  
FAX (312) 240-9007  
E-MAIL: [Garycooke2@aol.com](mailto:Garycooke2@aol.com)

**Botti Studio of Architectural Arts, Inc.**  
919 Grove St., Evanston, IL 60201  
847/869-5933 • Fax 847/869-5996  
800/524-7211 • [Botti@ix.netcom.com](mailto:Botti@ix.netcom.com)

Designers/Fabricators • Stained and Faceted Glass  
Beveled Glass • Sandblasted • Stained Glass Restoration  
and Conservation • Protective Glazing • Wood and Metal  
Frame Restoration • Sculpture • Bronze • Metal • Marble  
Mosaic • Interior Renovation • Woodwork • Murals  
Painting and Decorating • Custom Sanctuary Furnishings  
Stained Glass Consultants to Architects and Churches

**Field Representatives Nationwide**  
Studios: San Diego • Chicago • Sarasota  
619/753-0705 • 847/869-5933 • 941/951-0978

**INSURANCE SPECIALISTS FOR**  
Architects • Engineers • Land Surveyors

**AVA Insurance Agency, Inc.**

- Professional Liability
- Commercial
- Special Programs
- Group Health

*Serving You  
Since  
1979*

One Tower Lane, Suite 1440, Oakbrook Terrace, IL 60181  
(708) 571-4500 Fax (708) 571-4518 E-Mail: [INFO@AVAINS.COM](mailto:INFO@AVAINS.COM)



# Sabo & Zahn

Attorneys at Law  
Werner Sabo, AIA James Zahn, AIA

Copyrights for architectural works, litigation, arbitration,  
contracts, real estate construction attorneys.

**We've moved!**

8620 Sears Tower  
Chicago, IL 60606

(312) 655-8620  
Fax: (312) 655-8622

<http://www.sabozahn.com>

## OPTION 1

**Temporary placement** - CFA's total billing rate averages \$15 to \$45 per hour for entry to senior level staff. This price combines a fair market value for the temp's service (architects compensation) and fair market value for our service (CFA fixed fee) Our service includes recruiting, candidate interviewing, reference checking, and credit (cash flow financing) on weekly payroll. Also, our accounting department administers project time records, invoicing, accounts payable and collection. *This allows for risk-free, flexible, project-based staffing on an as-needed basis only.*



### Consulting For Architects, Inc. Placement Services

The Merchandise Mart, Suite 1049A, Chicago IL 60654  
(312) 822-0338 Fax 822-0342

"The leader in architectural recruiting and staffing"

## OPTION 2

**Technical Placement** - CFA will place a computer expert specializing in CAD and experienced with A/E/C installations to solve a variety of your office automation needs. CFA's total billing rate averages \$50 - \$150/hr. These skilled technicians can develop budgets & specifications, install, administer & trouble shoot Networks, PCs, or MACs, install CAD stations & software, train staff, provide DOS/SUN/UNIX/NOVELL/WINDOWS programming solutions, support IS or MIS, develop CAD standards and layering guidelines, provide telephone support, data integration, plotting, drawing conversion and more. *At no additional charge we evaluate your needs and assign a consultant to complete your project.*



### Consulting For Architects, Inc. Placement Services

The Merchandise Mart, Suite 1049A, Chicago IL 60654  
(312) 822-0338 Fax 822-0342

"The leader in architectural recruiting and staffing"

## OPTION 3

**Permanent placement** - No matter what experience or salary, CFA charges a fixed fee of \$3,650 if you hire our candidate. CFA does not charge based on a percentage of the candidate's annual salary. *When we do the same amount of work, why should a candidate's salary level result in higher fees to you?*



### Consulting For Architects, Inc. Placement Services

The Merchandise Mart, Suite 1049A, Chicago IL 60654  
(312) 822-0338 Fax 822-0342

"The leader in architectural recruiting and staffing"

## DO YOU NEED INFORMATION OR ASSISTANCE WITH ANY OF THE FOLLOWING?

Ornamental Plaster

Interior Gypsum Plaster

Portland Cement Plaster

Spray Fireproofing

Gunite Rock Work

Stucco Work

Scagliola

E.I.F.S.

Sgraffito

Cast Plaster

Racquetball Courts

Hydronic Heat in Plaster

Electric Heat in Plaster

**Just give us a call. We will  
be happy to serve you.**

## CHICAGO PLASTERING INSTITUTE

6547 N. Avondale Ave.  
Chicago, IL 60631  
(773) 774-4500





# Autodesk®

## Premier Training Center

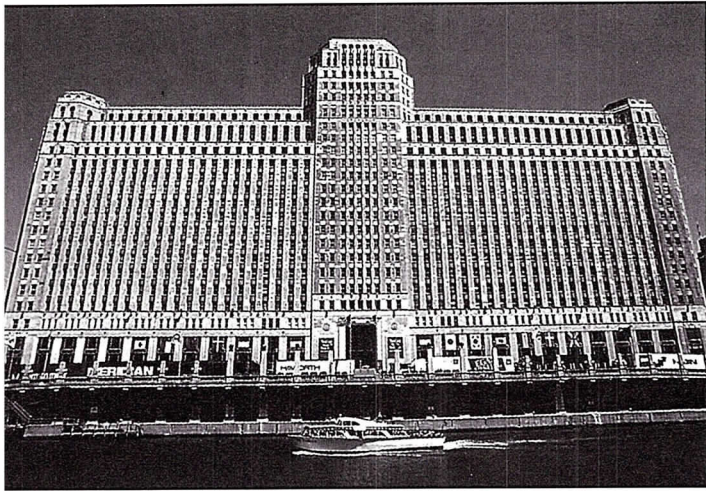

The Merchandise Mart, Chicago

### Why The CFA/CADD Training Center™ for CAD?

#### Award Winning ATC

- **Curriculum:** Autodesk ranked our curriculum, which is written specifically for architects and A/E/C professionals, "number two" in the country. Higher than any other licensed AutoCAD training center in Illinois.
- **Group of Instructors:** Autodesk ranked our group of instructors, all of whom are architects or design professionals, "number two" in the country. Higher than any other licensed AutoCAD training center in Illinois.
- **Individual Instructor:** Autodesk ranked our head trainer, Michael Horta, the "ninth best AutoCAD trainer" in the country. Higher than anyone at any other licensed AutoCAD training center in Illinois. He oversees the training at each CFA location.

#### Exceptional Learning Environment

- **Small Class Size:** An average of 4-6 students per class in an intimate learning environment • Taught by state-licensed instructors • Curriculum supports design and construction professionals including architects, engineers, interior designers and the building trades.
- **Design, Production, and Multimedia:** Autodesk's AutoCAD™, DataCAD, AutoVision, 3D Studio, form Z, Lightscape, Microstation™, MiniCAD, ARCH T, Auto-Architect and many others • DOS, WINDOWS, MAC
- **Flexible Schedules and Locations:** Morning, afternoon, evening and weekend sessions at your office or our convenient state-of-the-art downtown classroom facility. Handicapped and L accessible, and parking is close by.

- **Customized Training:** Our instructors are all current practitioners • Hands-on curriculum based exclusively on professional practice methods • Optional training by-the-hour
- **Accelerated Instruction:** No need to wait one year, or even one semester, to become more productive • Learn basic CAD in twenty hours • One- three- or five-week programs available • Intermediate, advanced and management courses also available • Ask for our full catalog
- **3 Months Free Lab Time:** Each class includes practice time in our completely updated computer lab • Reinforce what you have learned, or prepare a project for a job interview.
- **12 Free Seminars:** Once a month *The CFA/CADD Users Group* sponsors a free evening seminar on a CAD software application. These are not sales demo's, these are 12 free training seminars.

#### Superb Educational Credentials

- **Autodesk Premier Training Center:** As the producer of AutoCAD, the world leader in computer-aided design software, Autodesk Training Centers maintain the most rigorous and comprehensive educational programs; providing training of the highest quality for the widest range of professionals within the design industry.
- **Licensed by The State of Illinois:** The CFA/CADD Training Center™ is fully accredited as a private school. Our facilities and instructors must comply with strict standards of excellence, audited and monitored on an annual basis.
- **AIA/CES Provider:** Our program meets AIA/CES Quality Level 3 criteria • Participants earn 60 LU's (learning units) for each 20-hour course.

#### Convenient Chicago Location:

Consulting For Architects, Inc.  
 The Merchandise Mart • Room 1049A • Chicago, IL 60654  
 Tel: 312-822-0338 Fax: 312-822-0342

VISIT A CLASS IN PROGRESS!

**Reserve your classes now.**  
**Call The CFA/CADD Training Center™**  
**at 1-800-599-8882**  
**and ask for Harry Lane**



**5 Chicago Architecture Foundation.** Brown bag lunch. Building a Downtown for Schaumburg. 12:15 p.m.; Lecture Hall, 224 S. Michigan Ave. Information: 312/922-3432.

**Young Architects PIA.** Marshall Strabala of SOM. 6:00 p.m.; Skidmore Owings & Merrill LLP, 224 S. Michigan Ave. Register on page three. *2 LUs.*

**11 Corporate Architects PIA.** Monthly meeting. 6:00 p.m.; AIA Chicago.

**12 Planning & Urban Affairs PIA.** Monthly meeting. 12:00 noon; AIA Chicago.

**Chicago Architecture Foundation.** Brown bag lunch. Wacker Tower Private Residence: Reuse of an Historic Skyscraper. 12:15 p.m., Lecture Hall; 224 S. Michigan Ave. Information: 312/922-3432.

**Architecture for Health PIA.** Facility Planning for Obstetrical Services. 5:30 p.m.; AIA Chicago. Register on page three. *3 LUs.*

**Architectural Woodwork Institute.** Veneer Slide Show and Panel Discussion. 4:30 p.m.(registration); 5:00 p.m. (presentation). Como Inn, 546 N. Milwaukee Ave. \$35 per person. Information and reservation: 630/790-2219.

**13 Historic Resources PIA.** Monthly meeting. 5:30 p.m.; AIA Chicago.

**Computer Aided Facility Management Council.** Customizing Auto CAD Menu. 9:00 a.m.; Evanston Hospital. Call Julie Ford, 847/570-2638, for directions.

**18 Environment PIA.** Brown Fields. 6:00 p.m.; AIA Chicago. Register on page three. *3 LUs.*

**19 Construction Industry Affairs Committee.** Monthly meeting. 8:30 a.m.; AIA Chicago.

**Chicago Architecture Foundation.** Brown bag lunch. Adler Planetarium & Astronomical Museum: East Pavilion Addition. 12:15 p.m.; Lecture Hall, 224 S. Michigan Ave. Information: 312/922-3432.

**Office Practice PIA.** Instant, Instinctive Marketing Part I.; 5:30 p.m.; AIA Chicago. Register on page three. *3 LUs.*

**20 Government Affairs PIA.** Monthly meeting. 12:00 noon; AIA Chicago.

**25 Education PIA.** Monthly meeting. 5:30 p.m.; AIA Chicago.

**Design PIA.** 1996 Design Excellence Awards Submissions. 5:30 p.m.; AIA Chicago.

**Construction Specifications Institute.** New CSI MasterFormat. 5:00 p.m. (reception); 6:00 p.m. (program). Second floor of the IBM Building, 330 N. Wabash Ave. Reservations: 312/641-5986.

**26 Chicago Architecture Foundation.** Brown bag lunch. Chicago's Terra Cotta Treasures. 12:15 p.m.; Lecture Hall, 224 S. Michigan Ave. Information: 312/922-3432.

**Real Estate PIA.** Monthly meeting. 5:30 p.m.; AIA Chicago.

**27 Technical Issues PIA.** Monthly meeting. 12:00 noon; AIA Chicago.

**Interior Architecture PIA.** Monthly meeting. 5:30 p.m.; AIA Chicago.

## AIA Chicago



A Chapter of The  
American Institute of Architects  
222 Merchandise Mart Plaza  
Suite 1049  
Chicago, Illinois 60654  
312/670-7770  
312/670-2422 (fax)  
aiachgo@mcs.com